

E100

E50

0

W50

-S50

N200

N150

N110

N70

N30

0

-N200

-N150

-N110

-N70

-N30

0

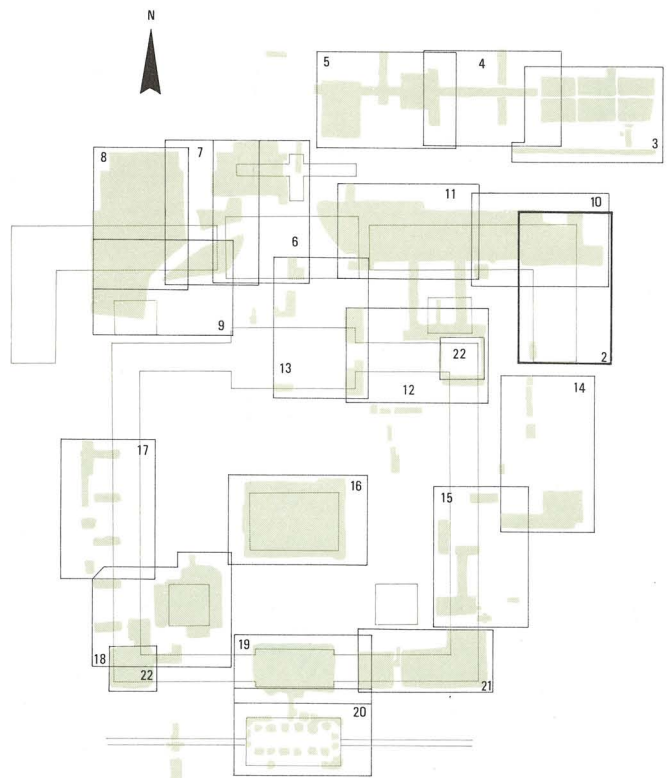



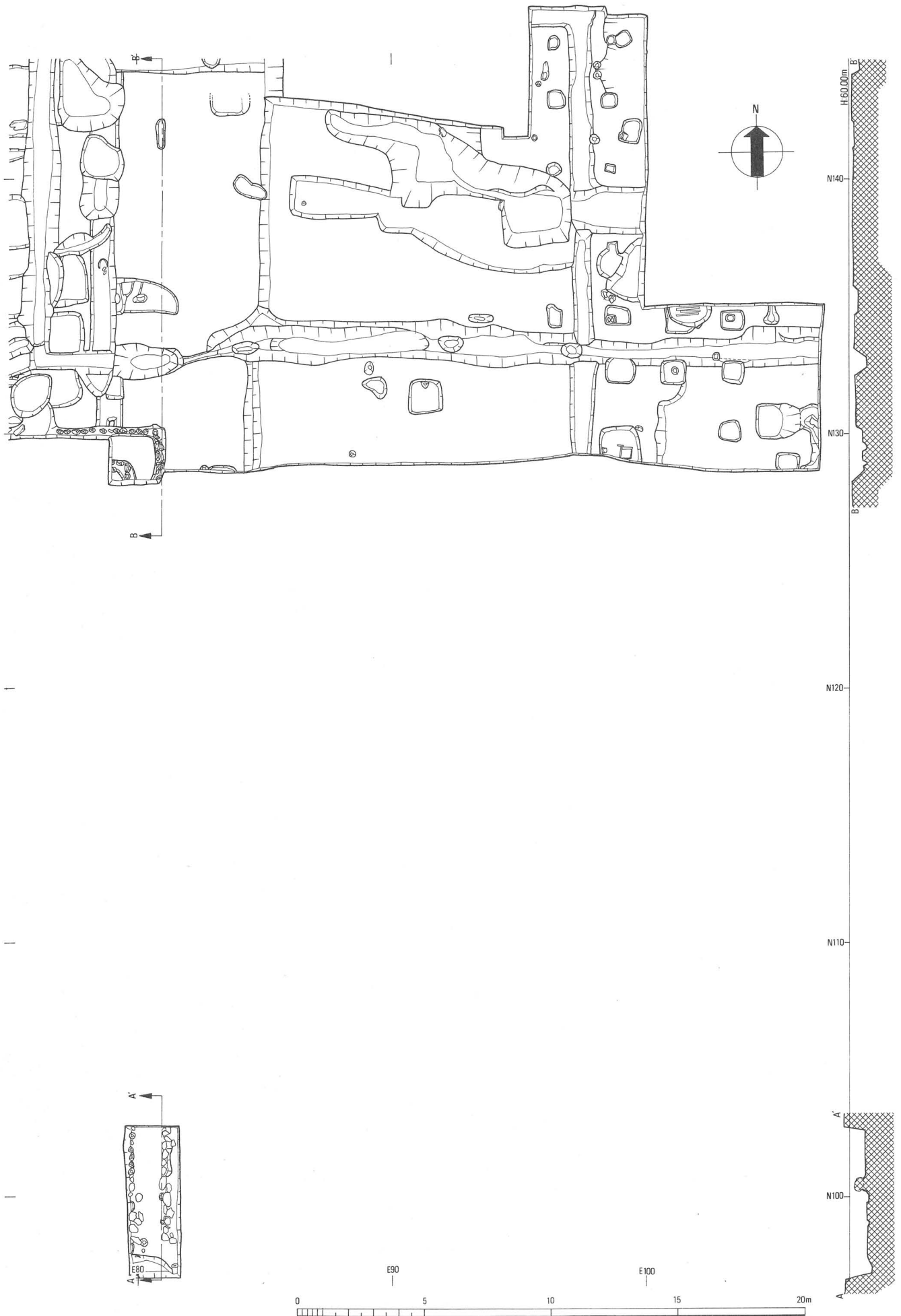

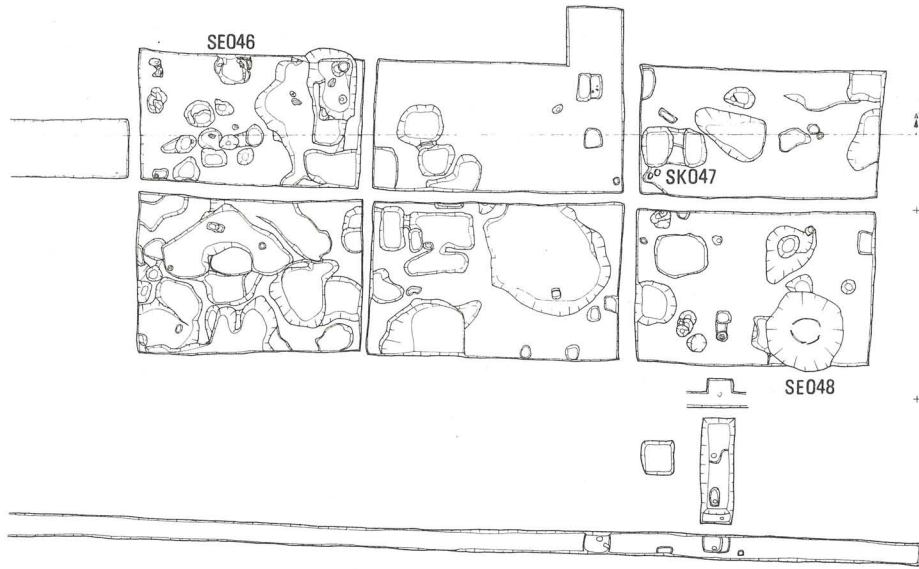



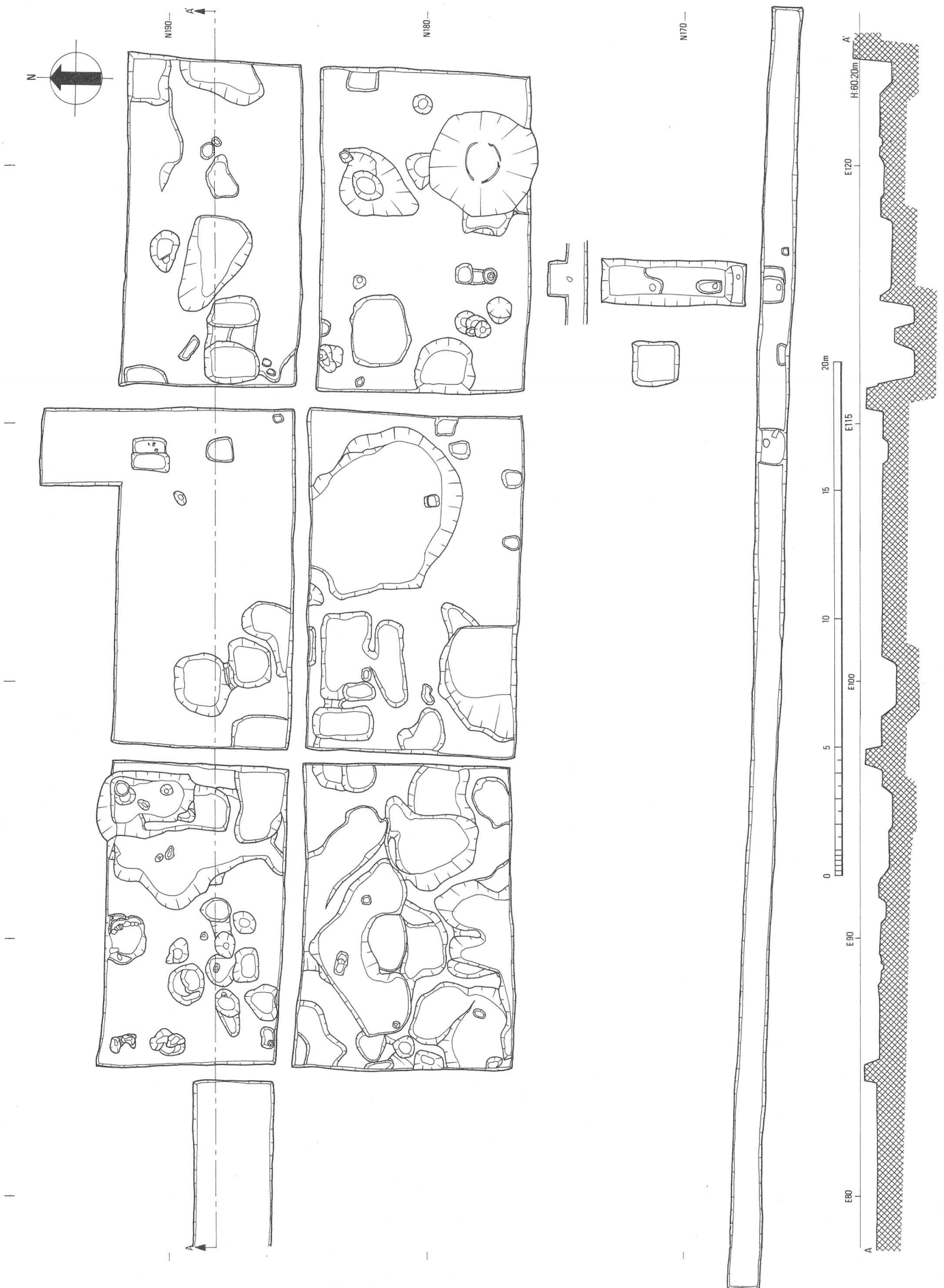

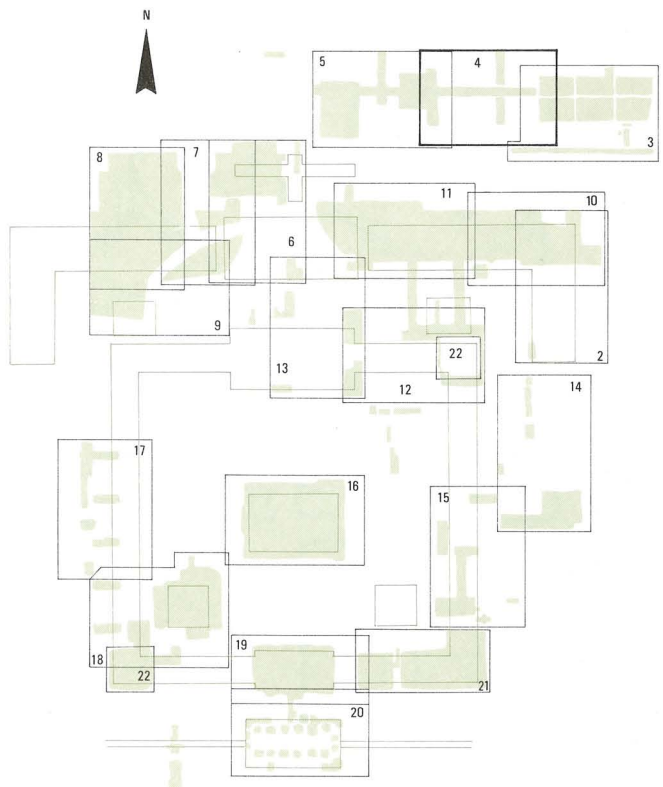

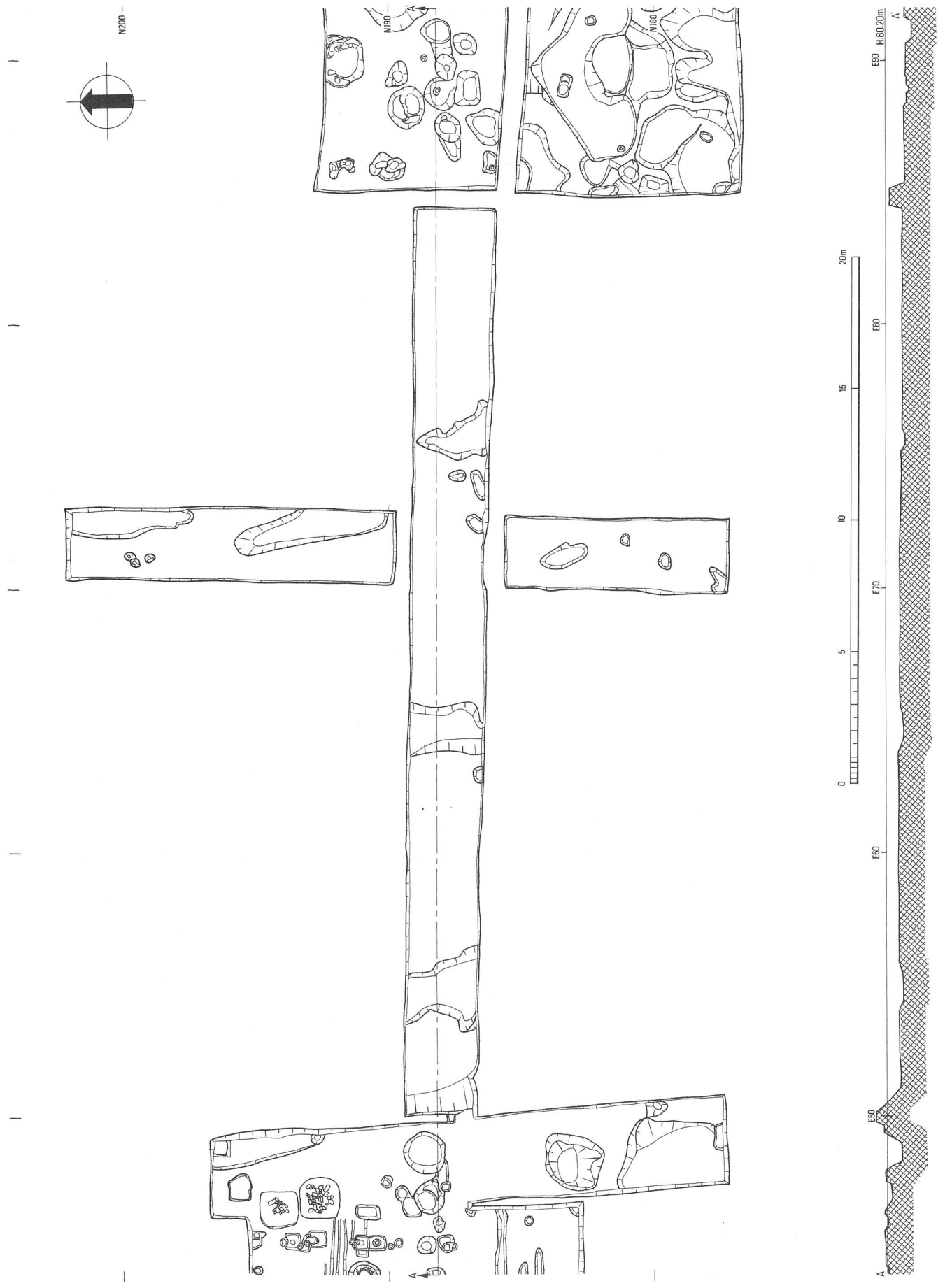



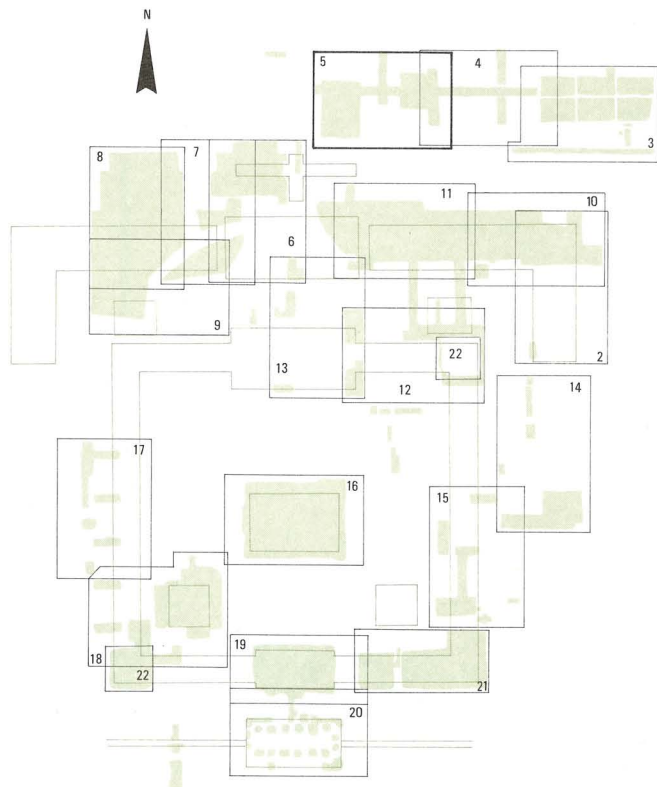
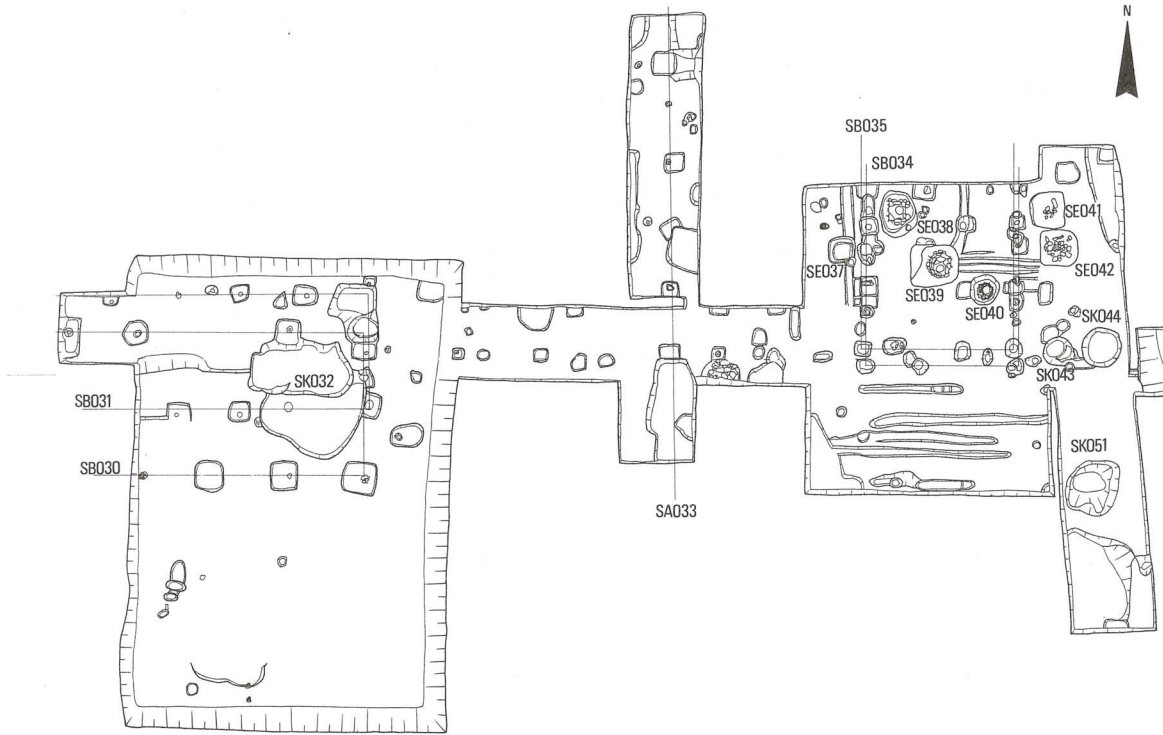

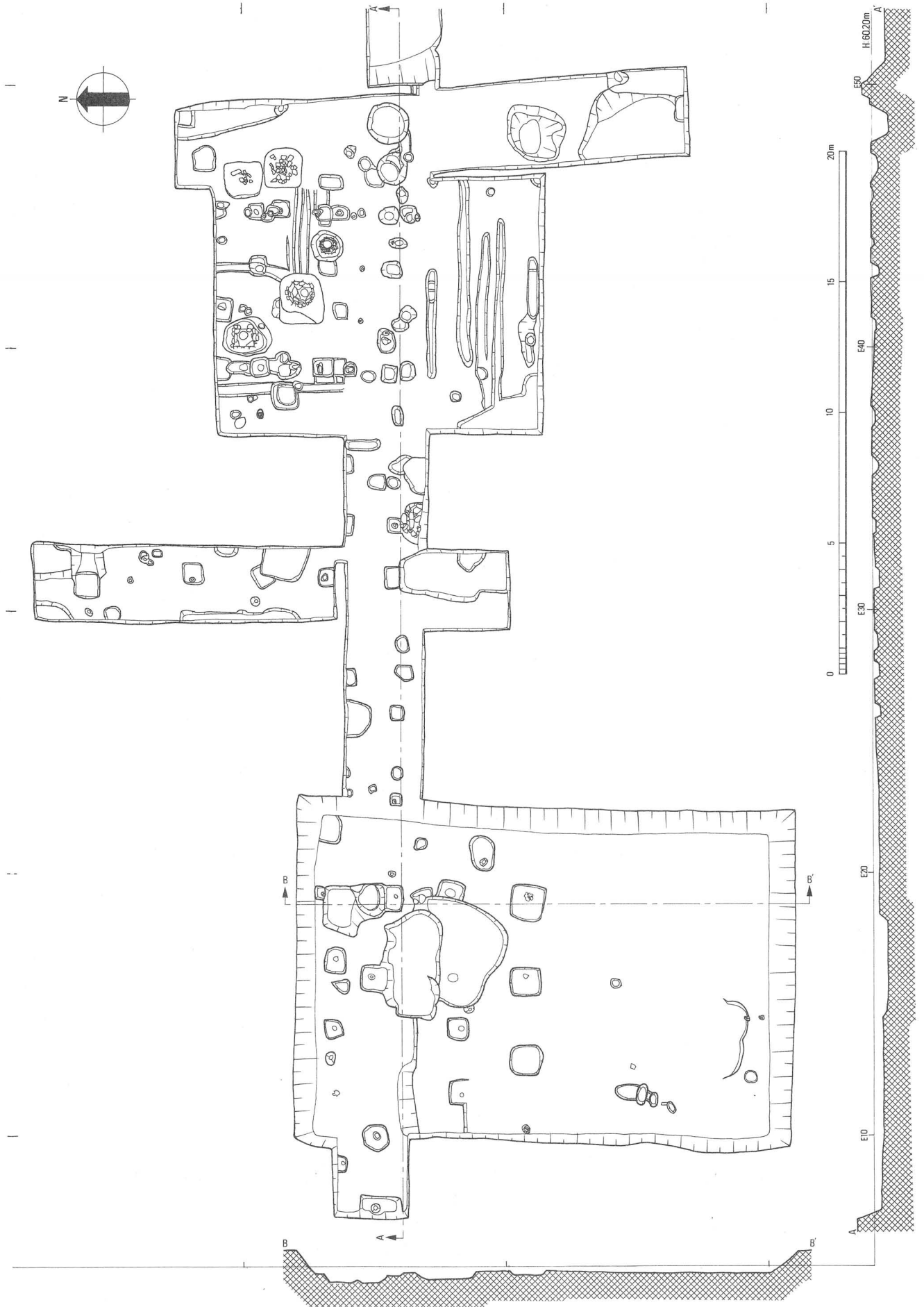

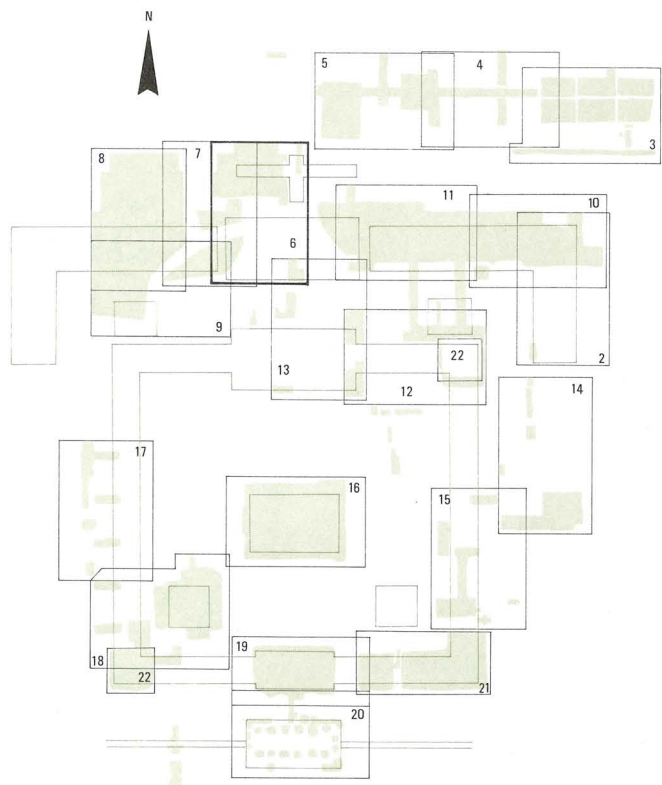
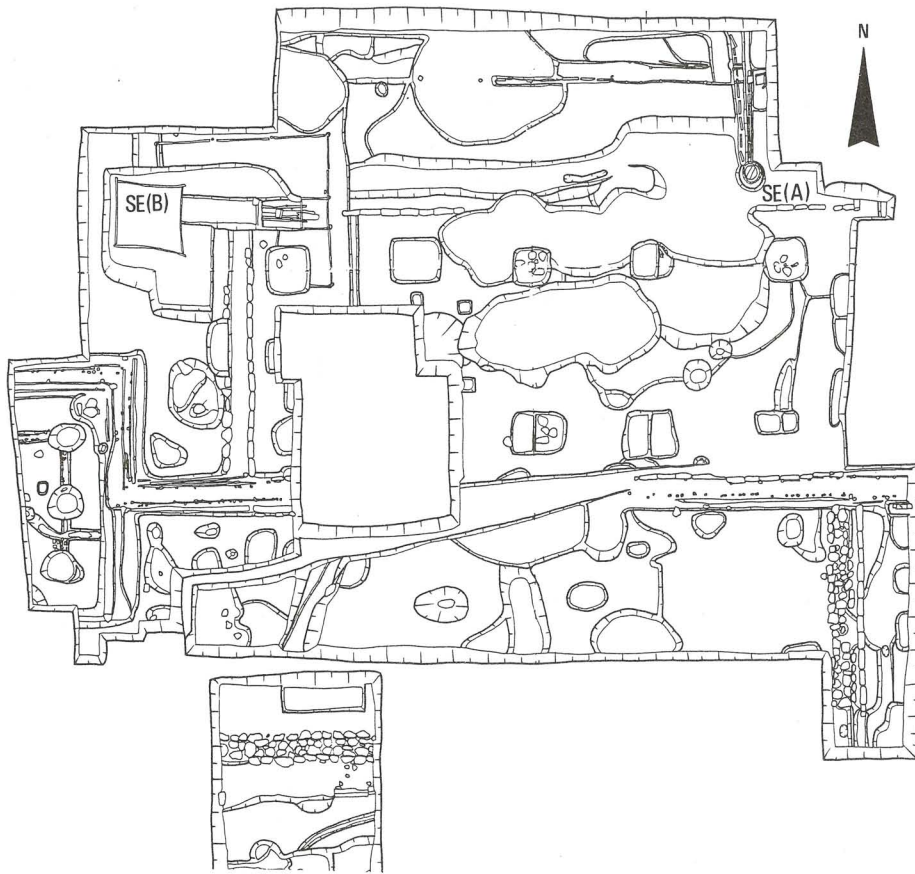



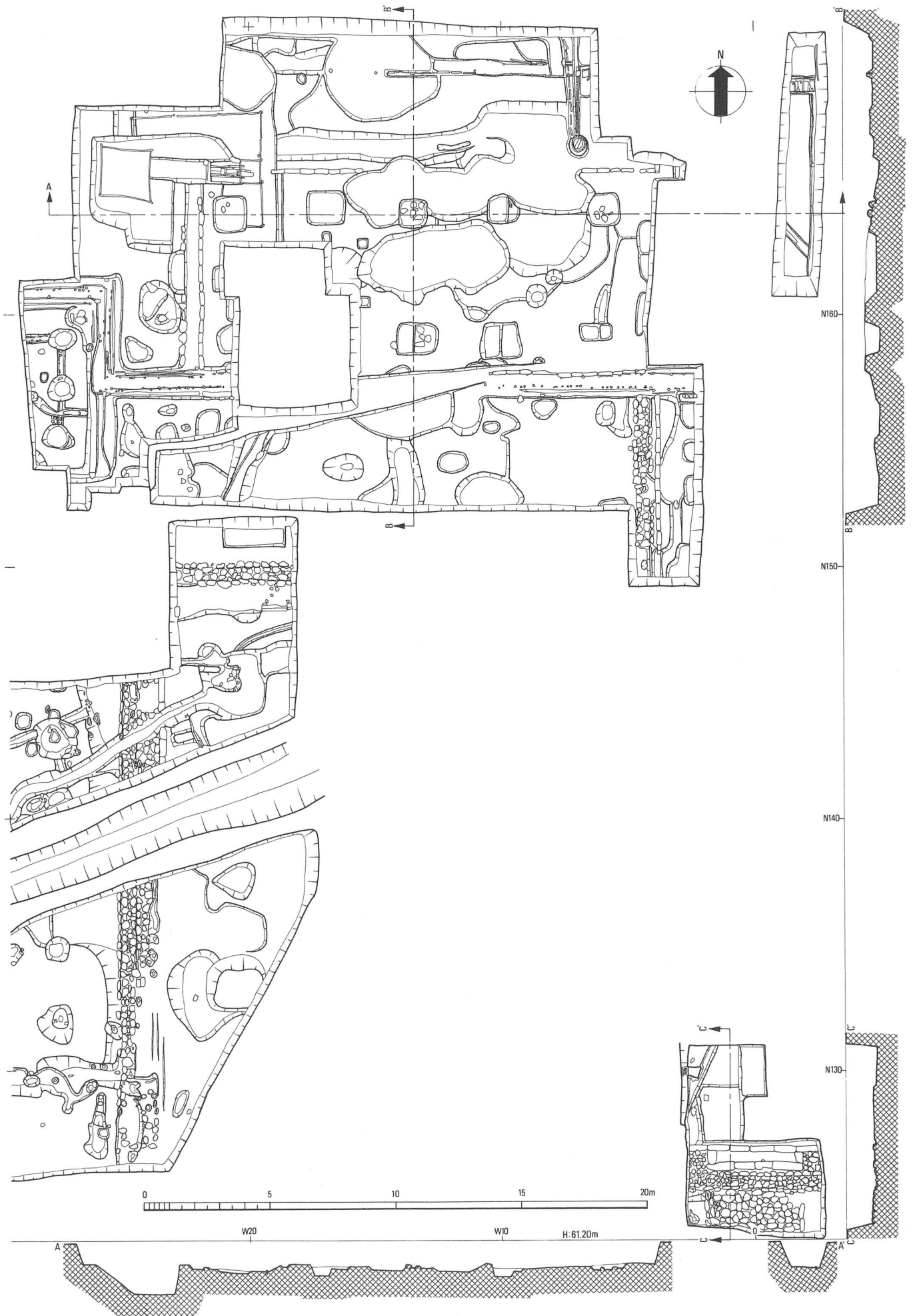



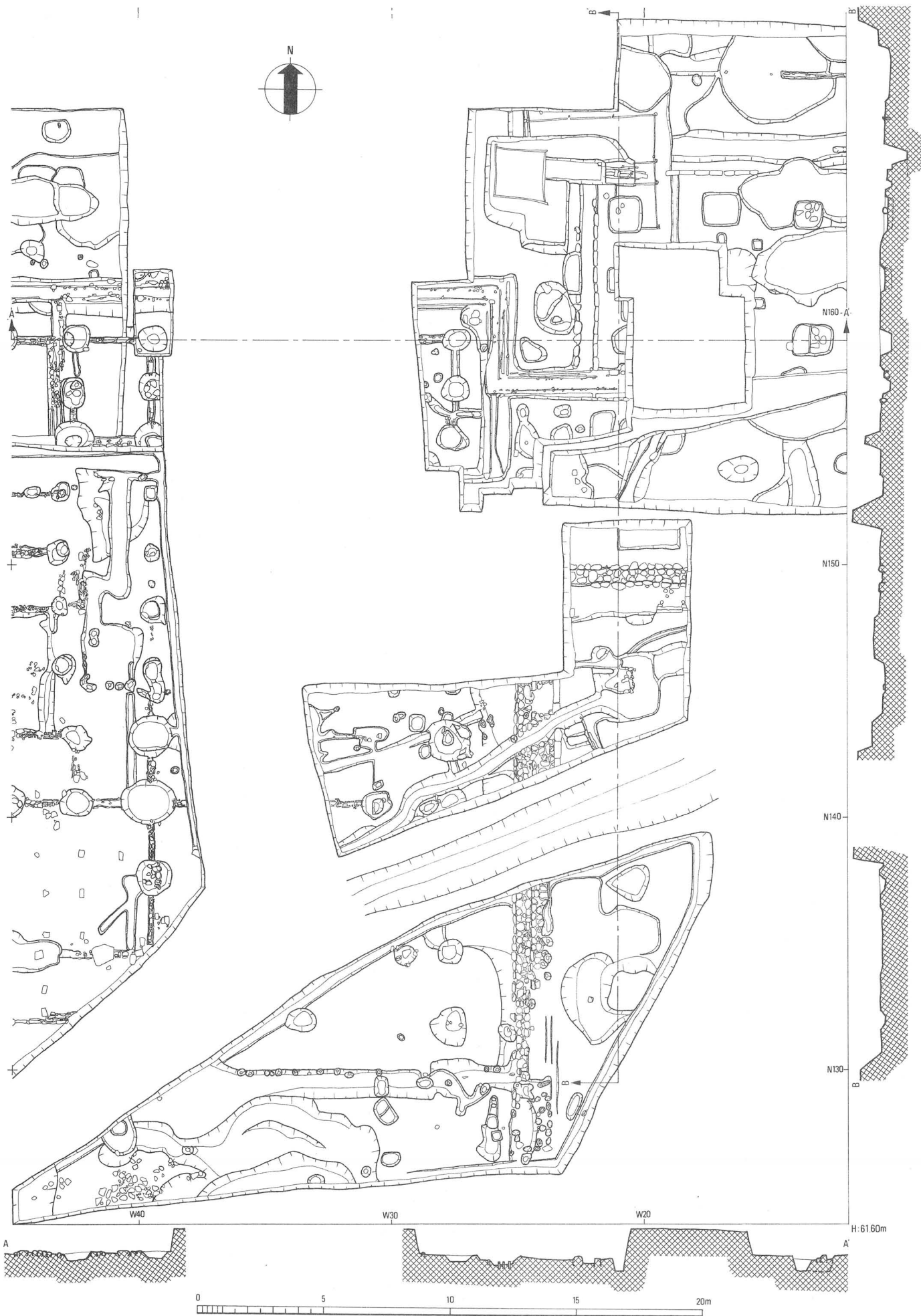



西僧房平面模式図

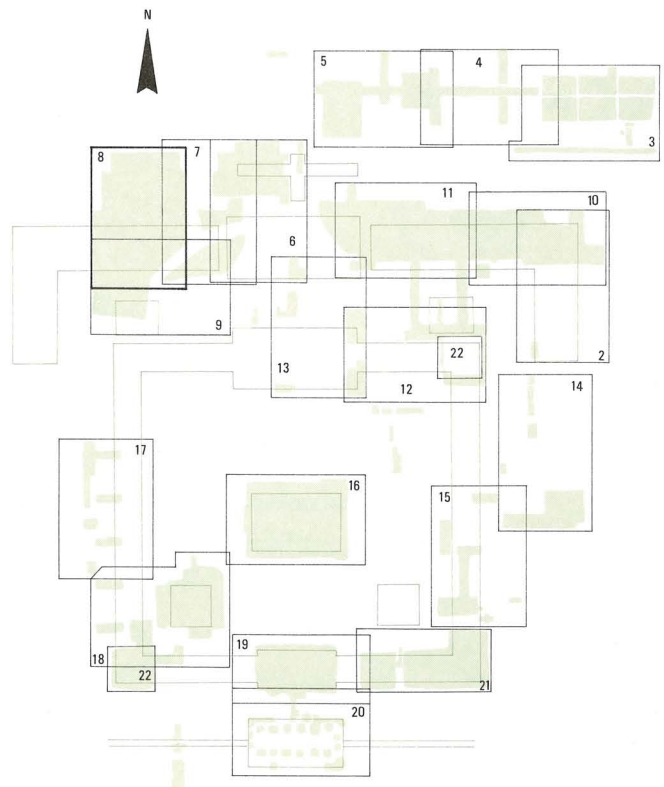
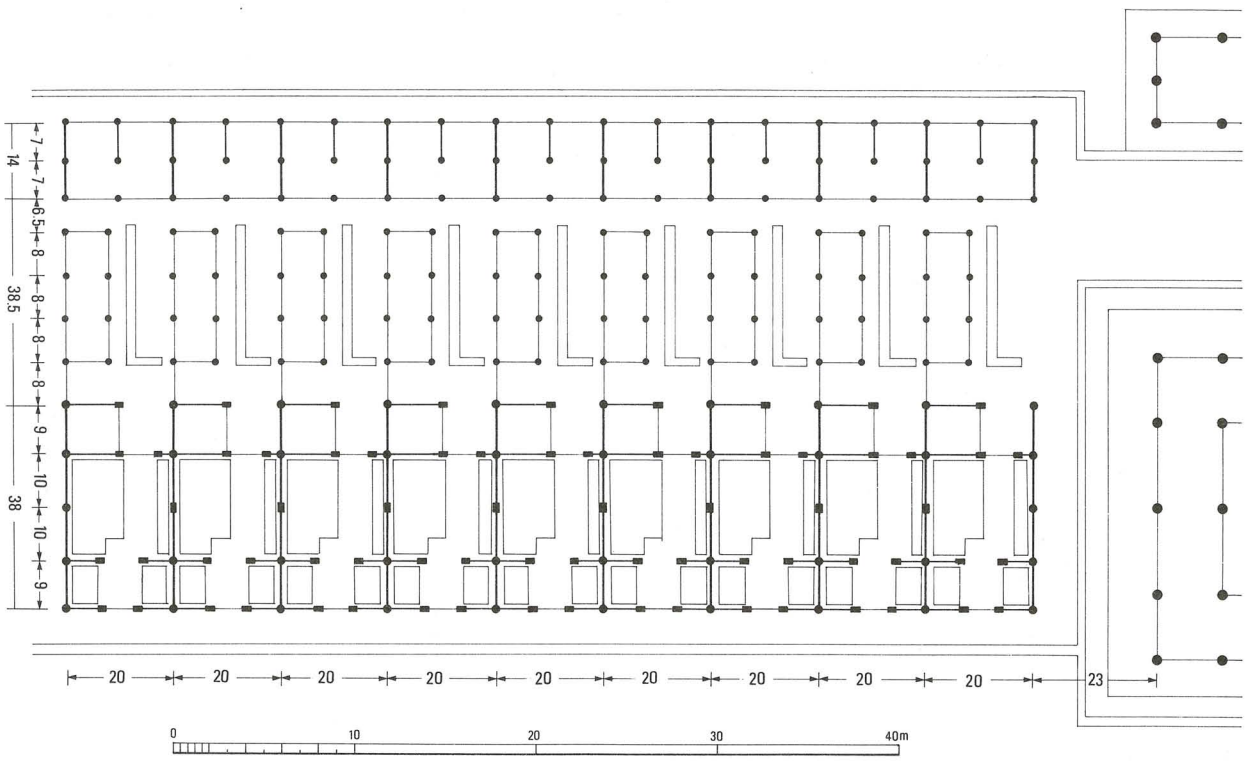

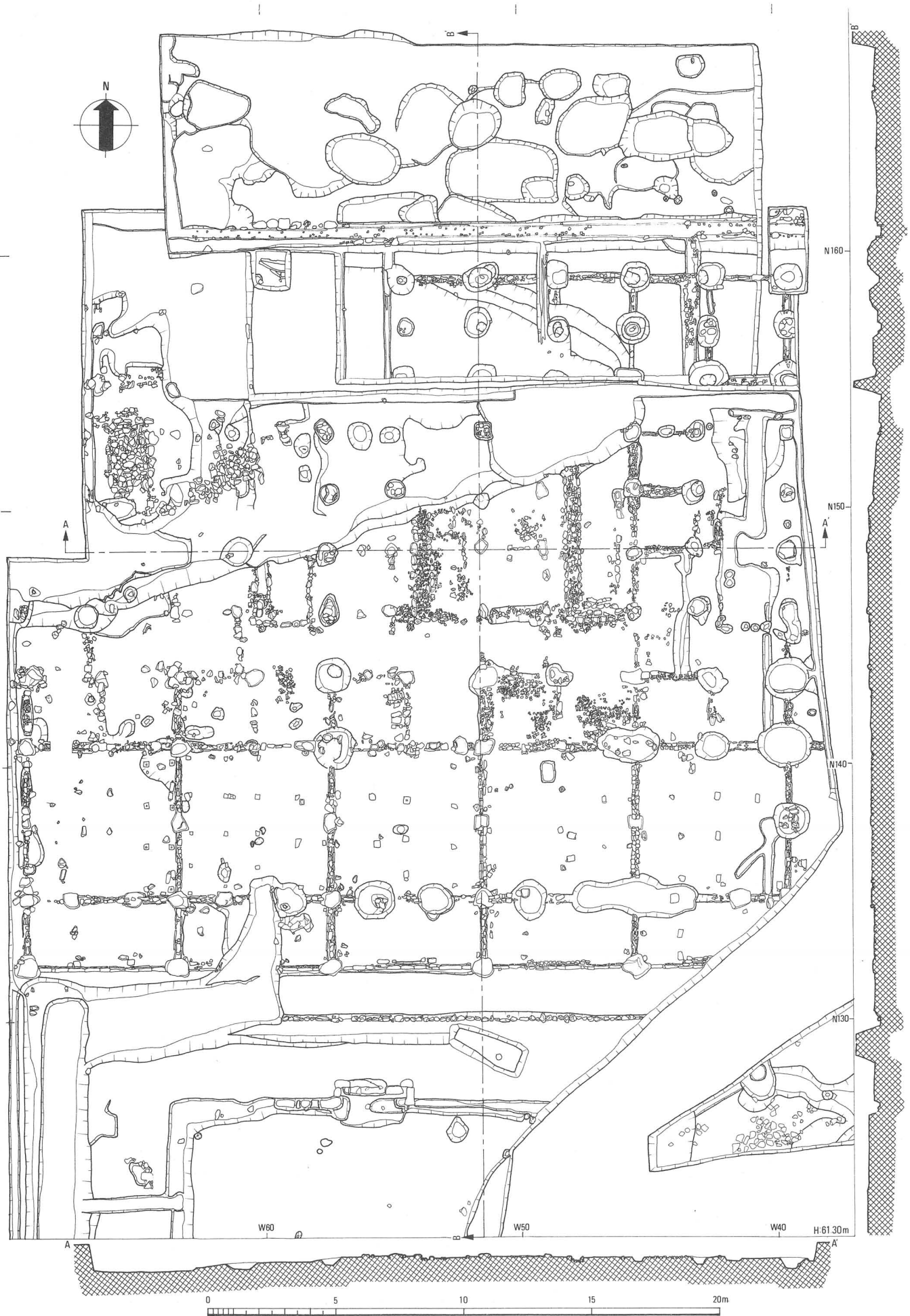

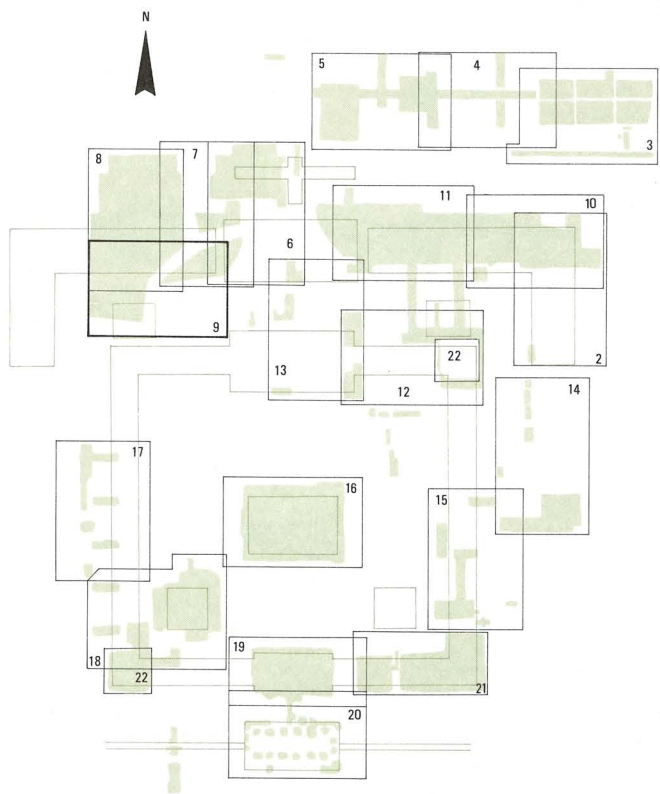

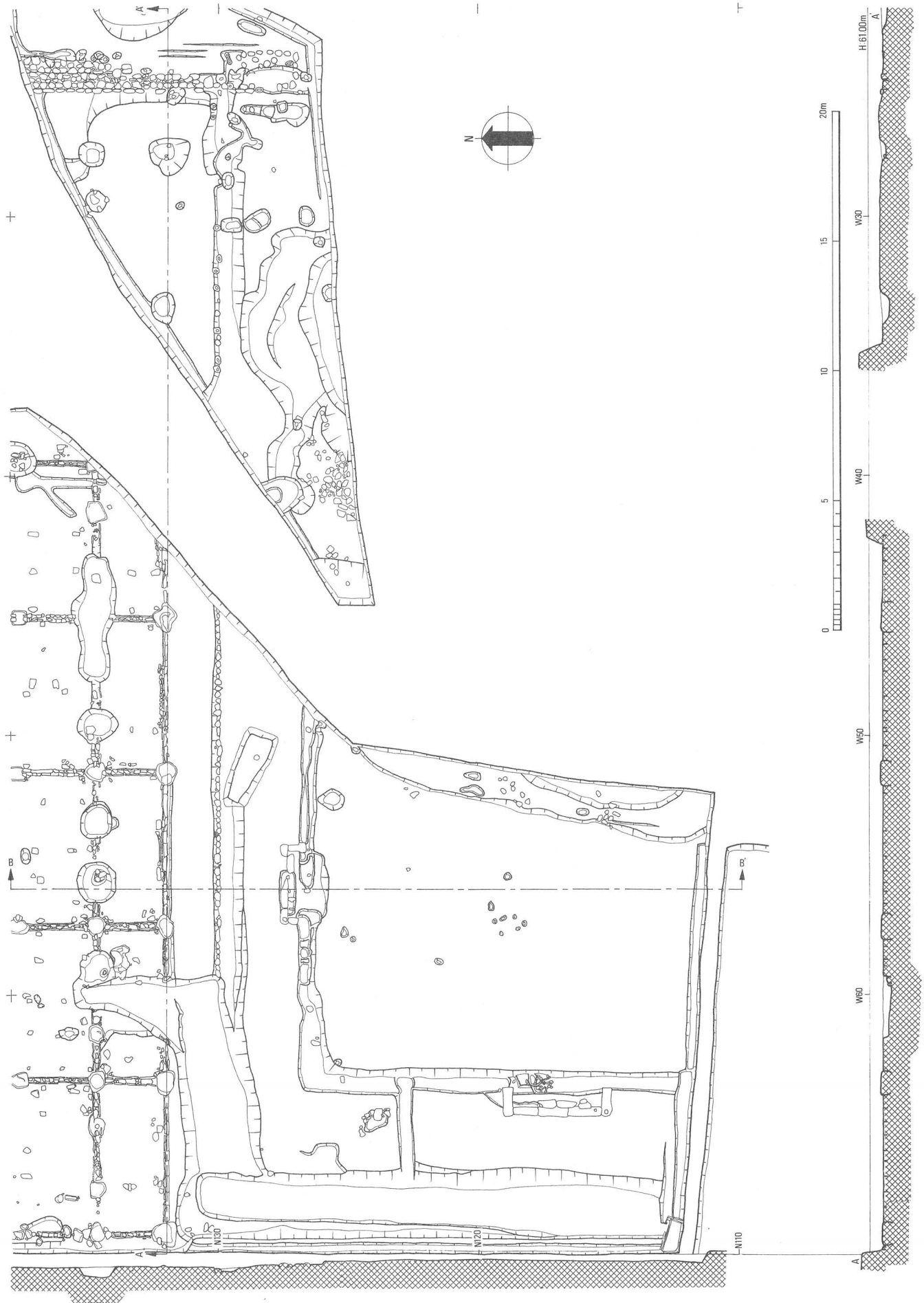



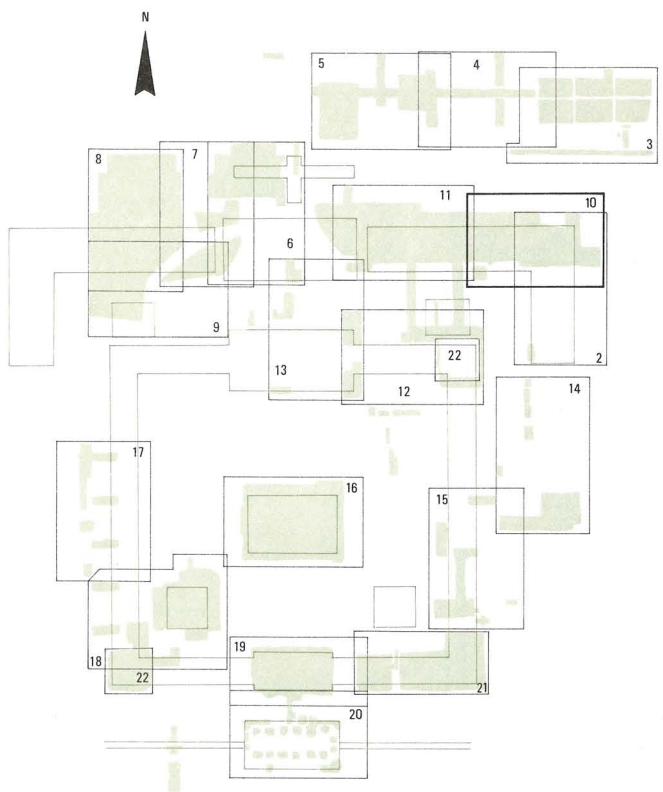

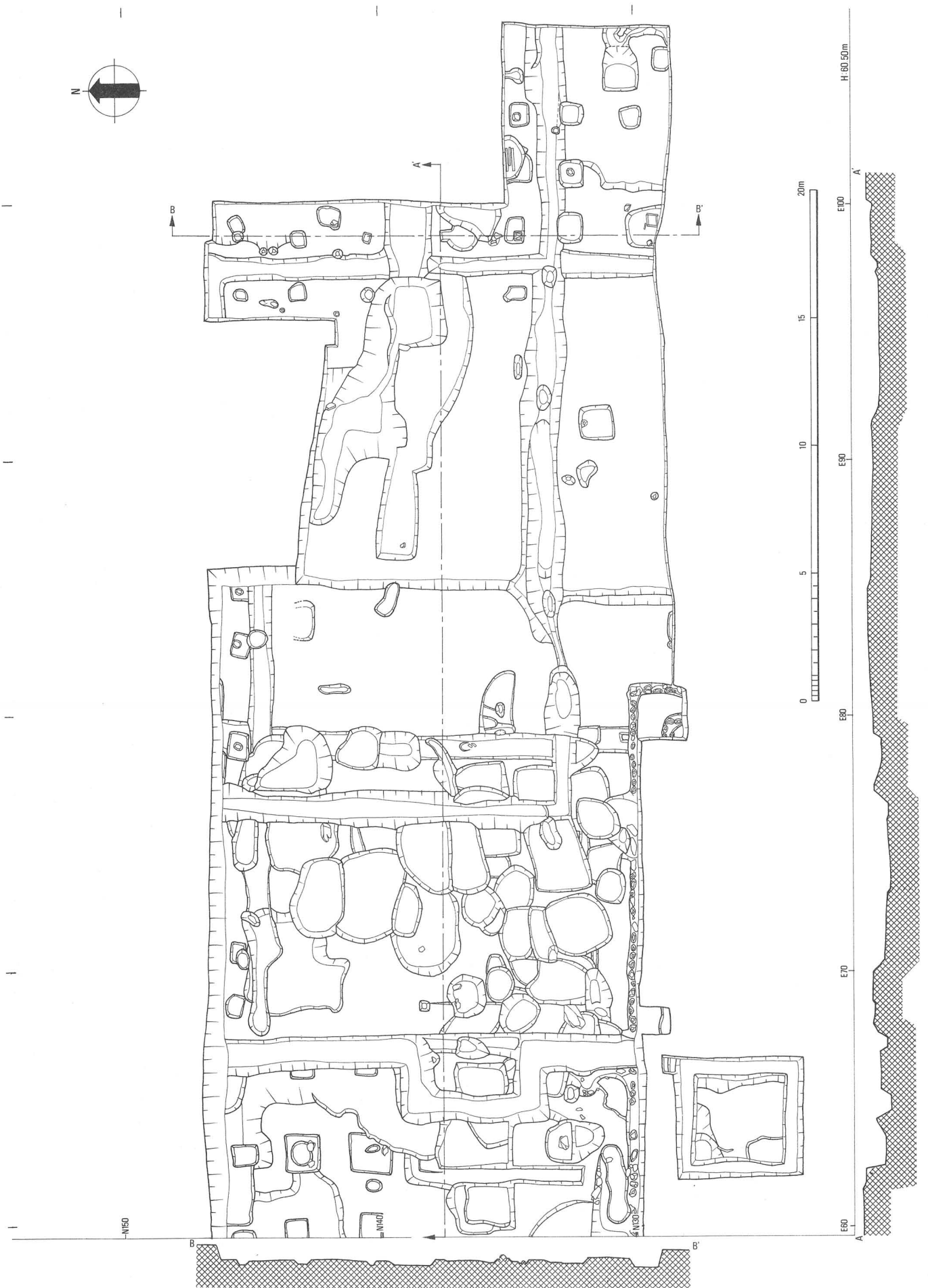

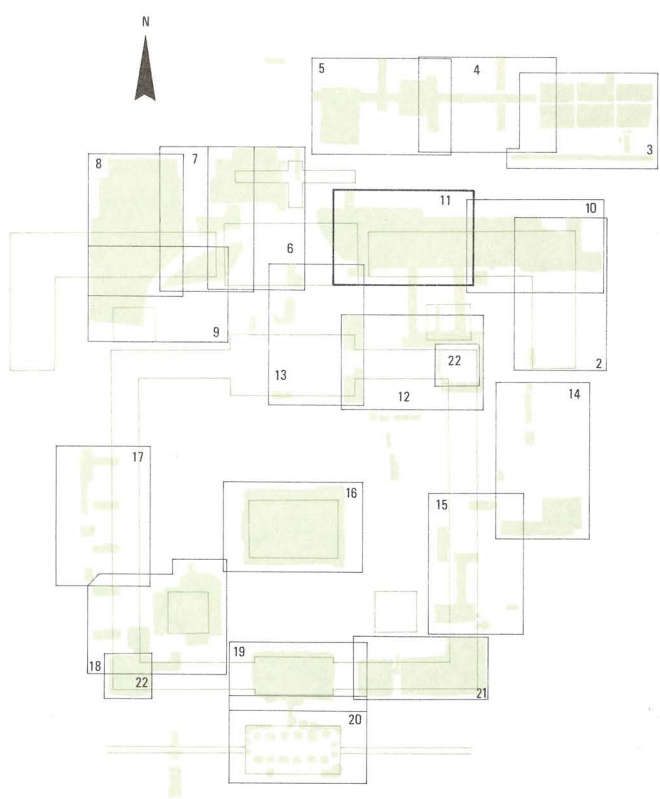
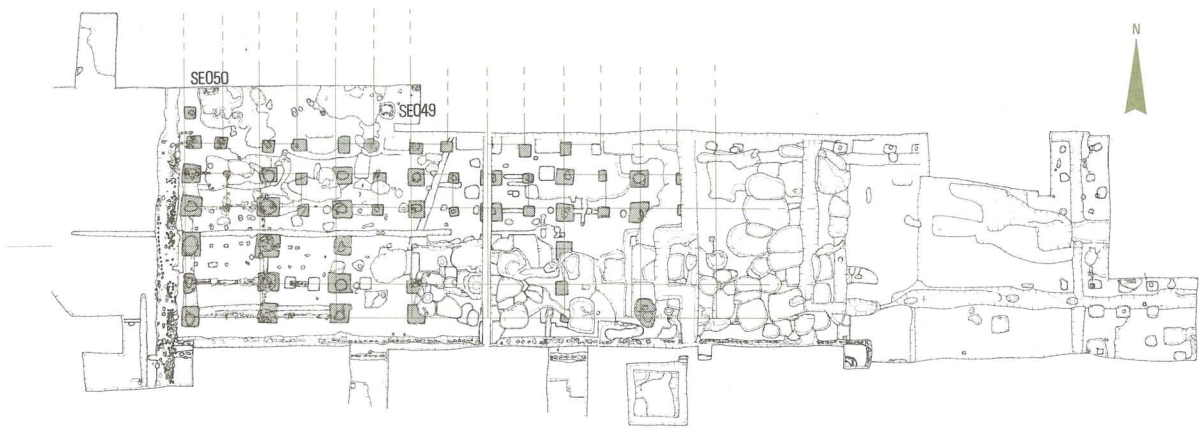

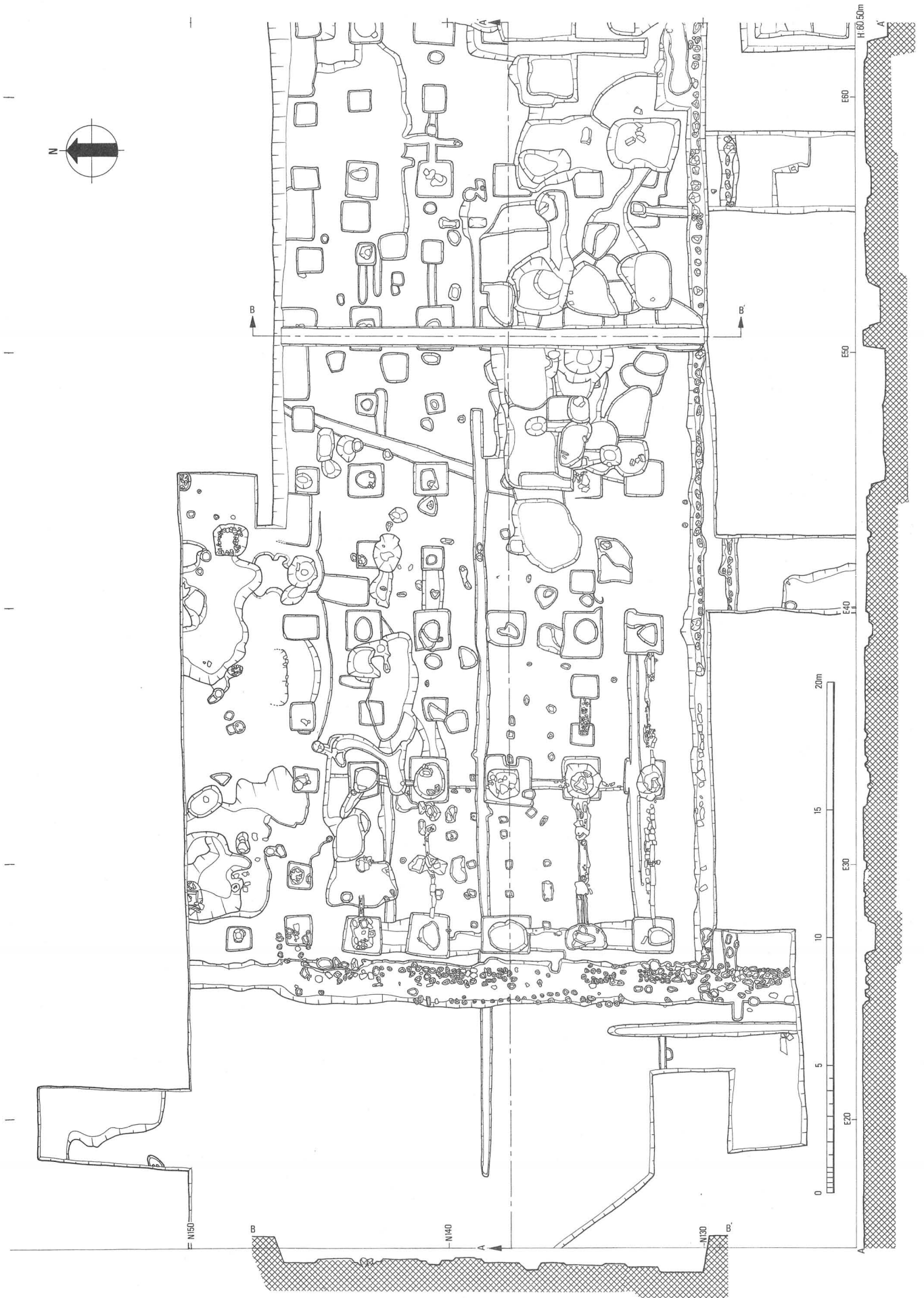





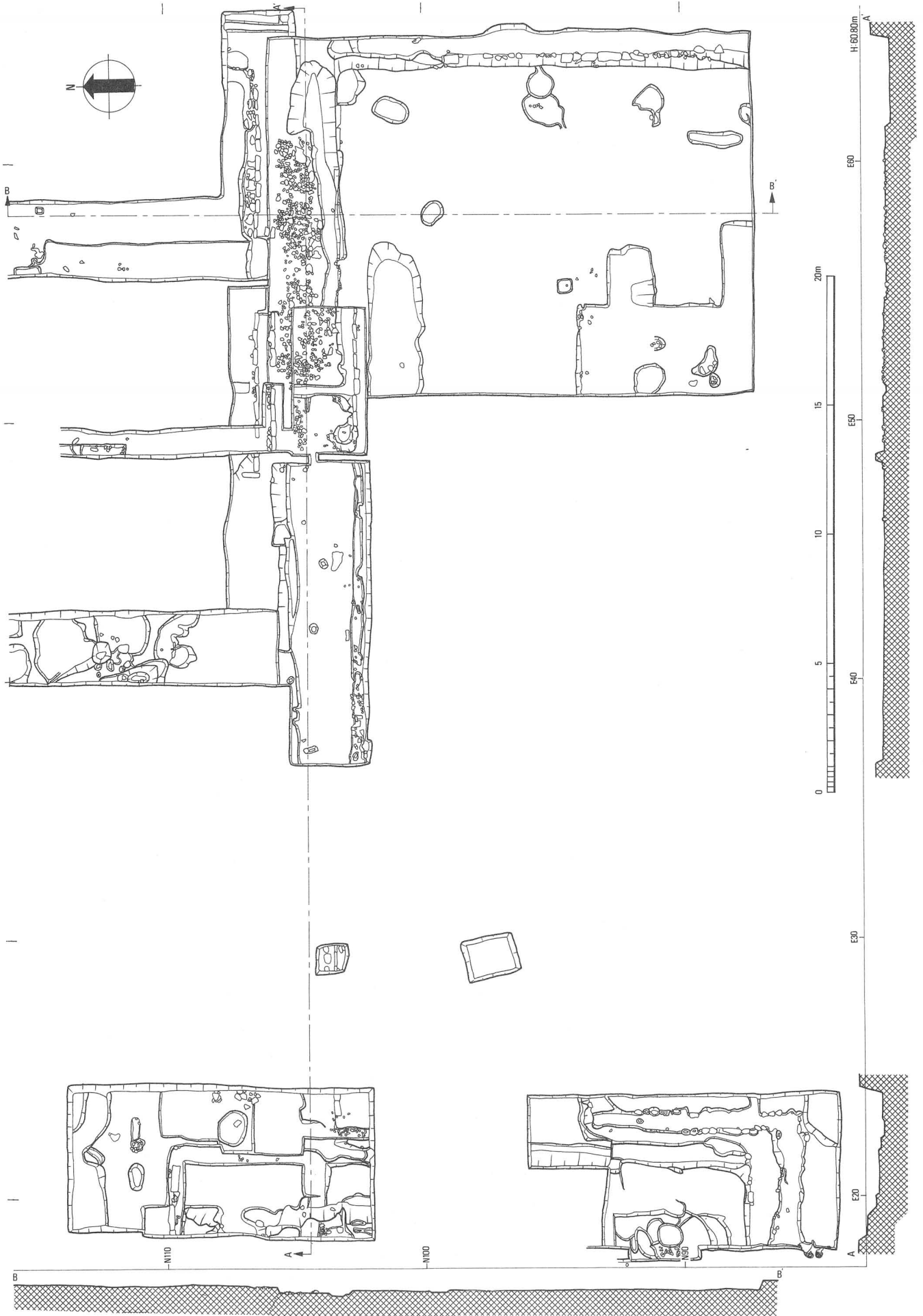

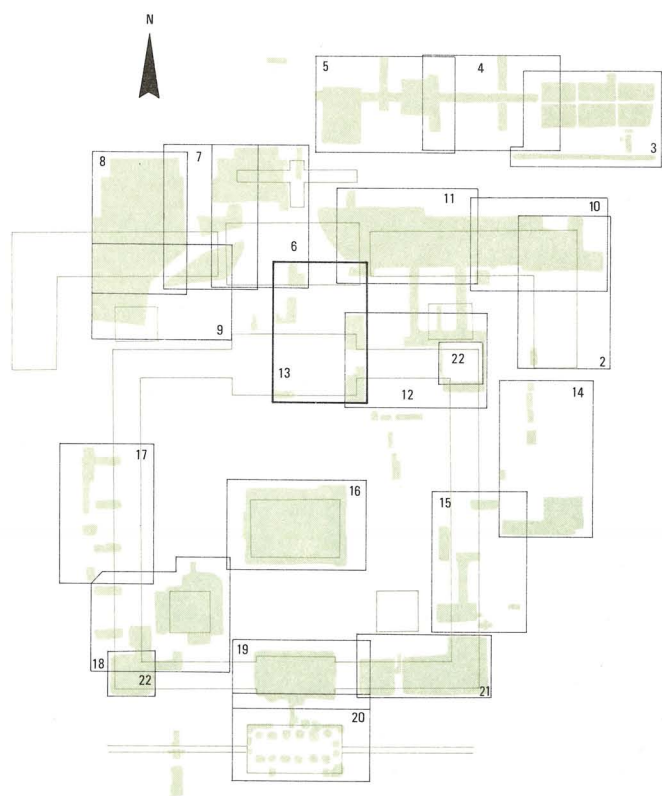

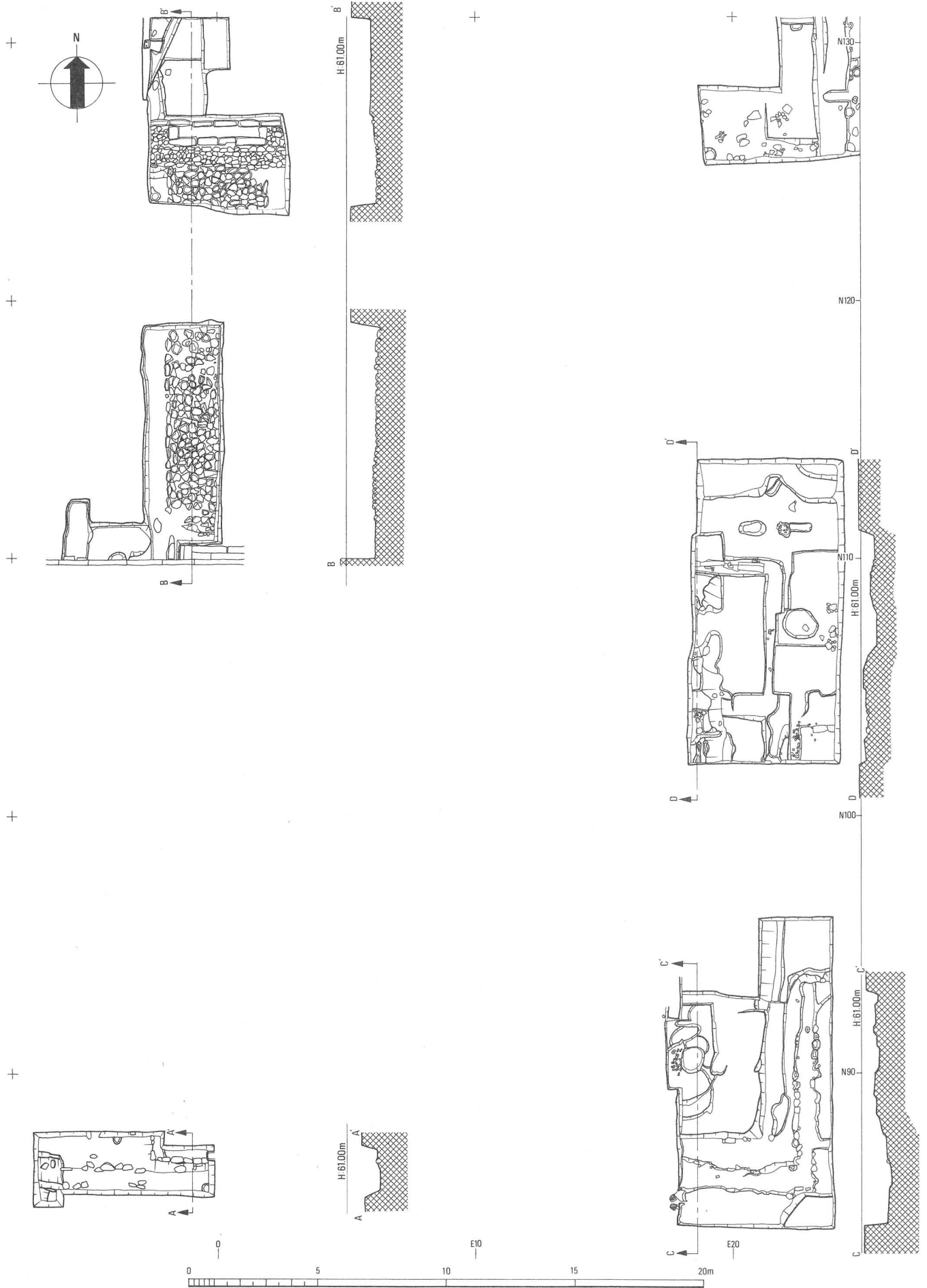

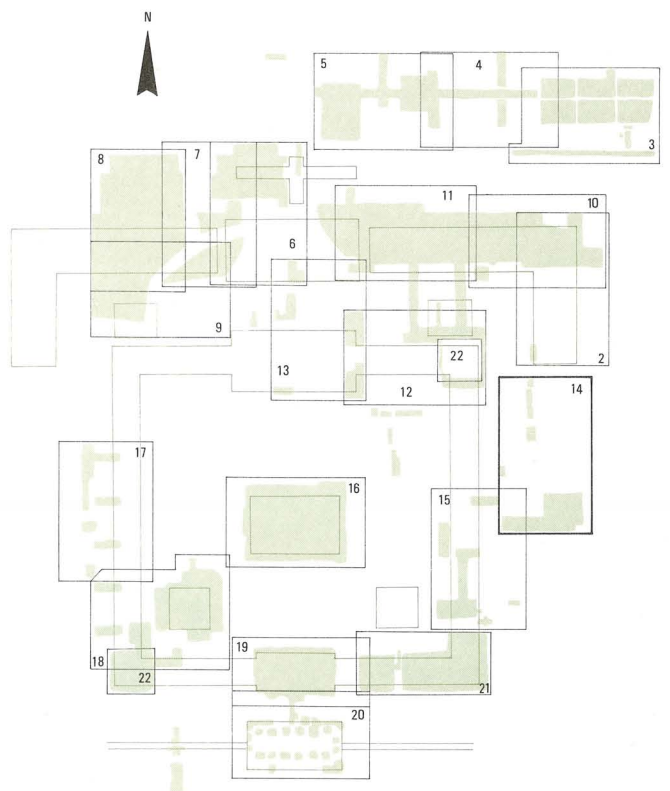



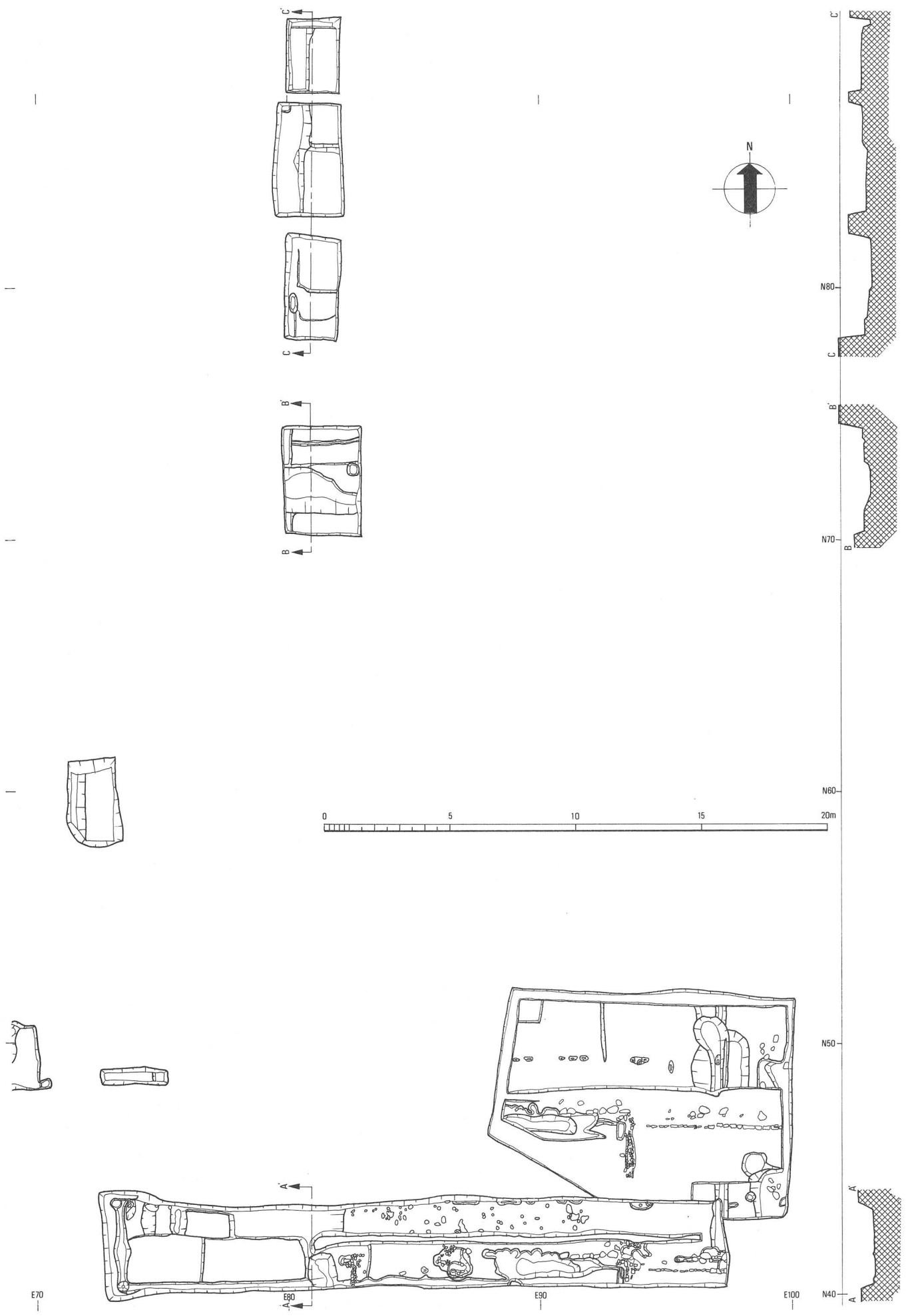

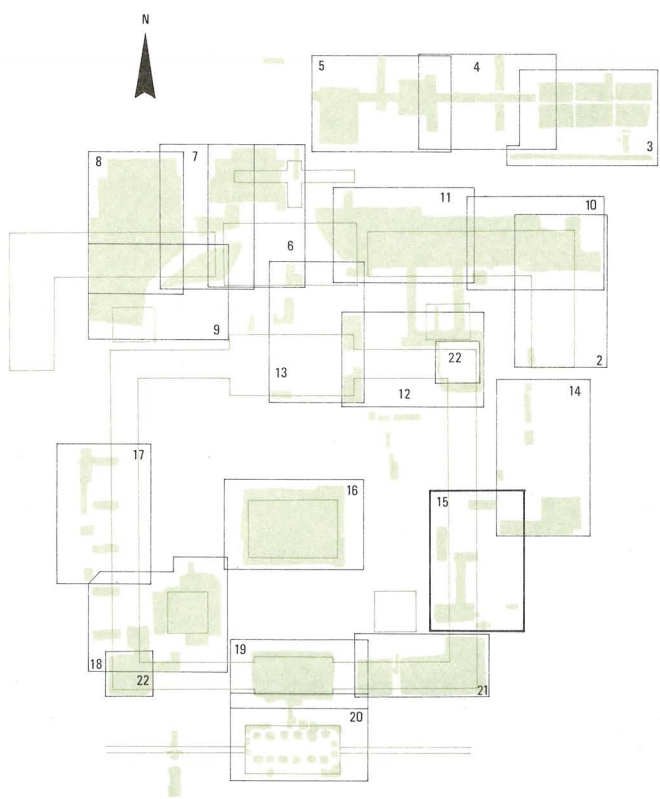

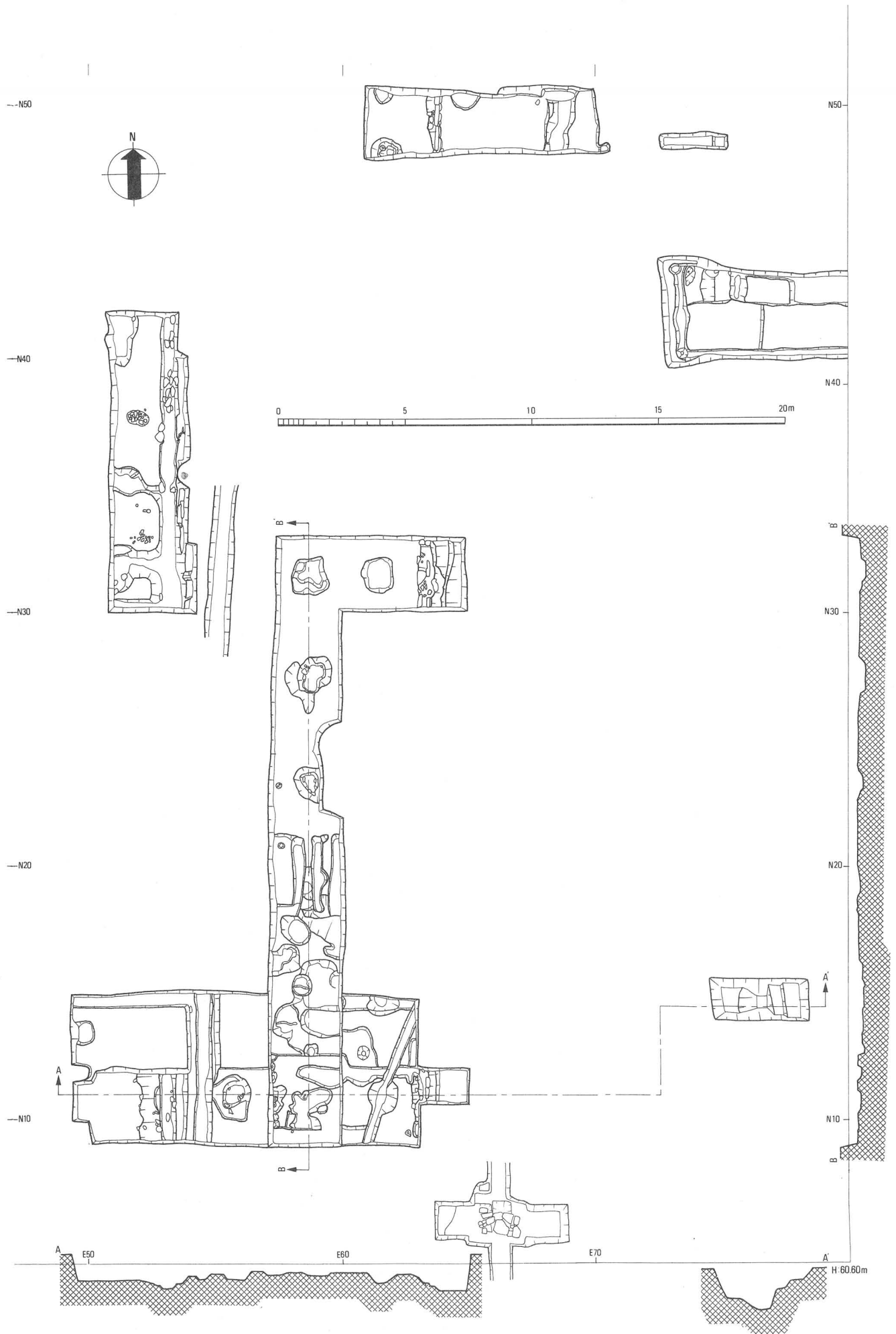

金堂礎石配置

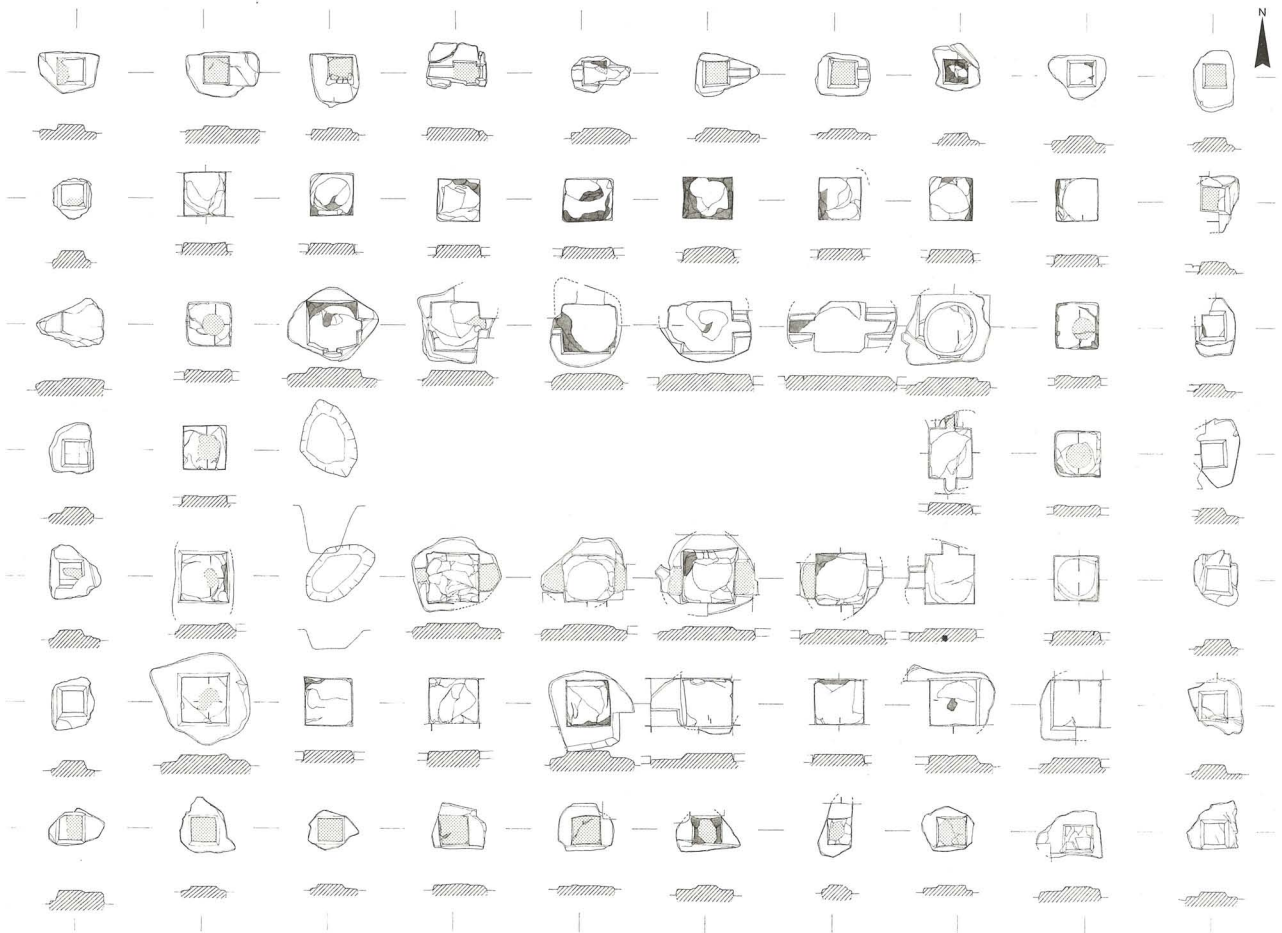

(上図は礎石を1個1個図示したものであり、柱間寸法については、Fig.21を参照のこと。)

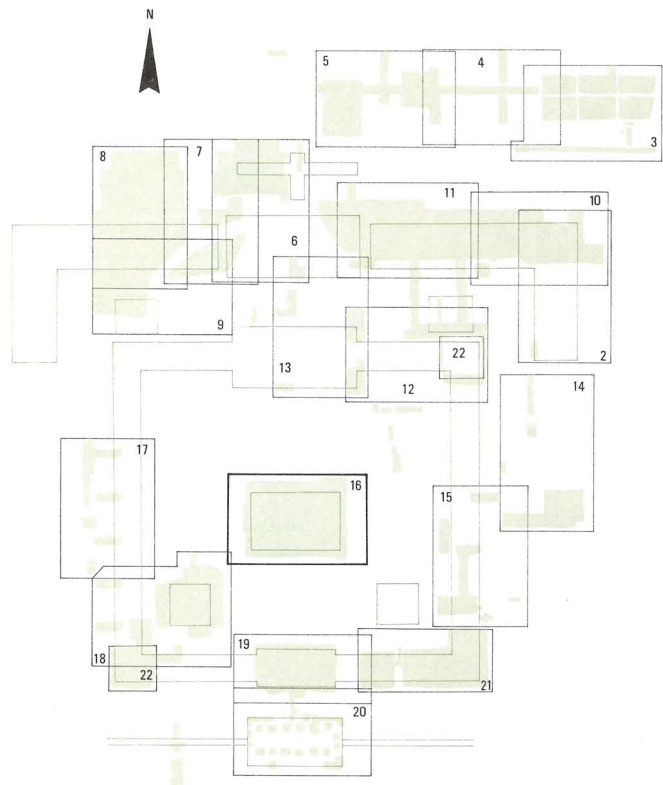

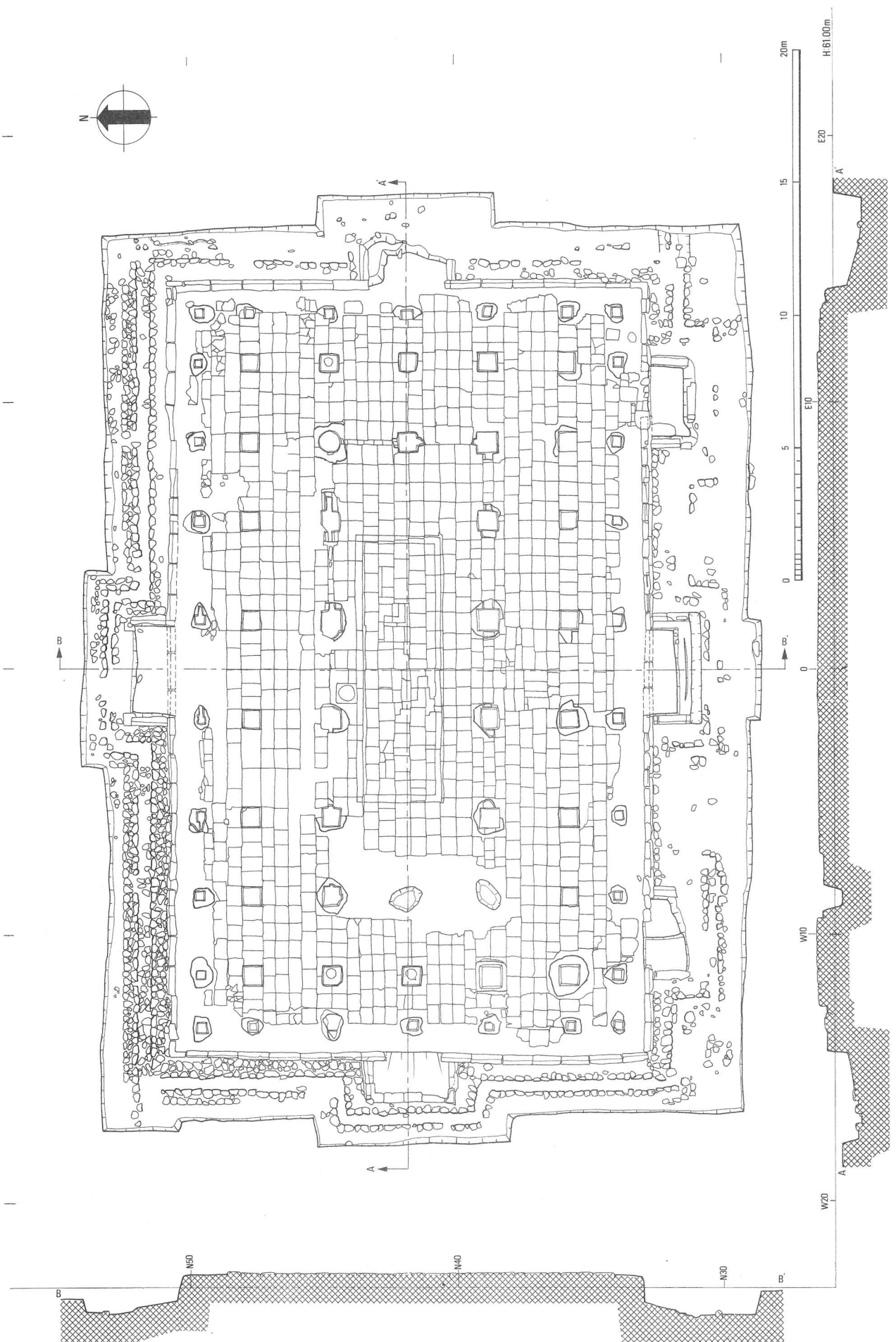



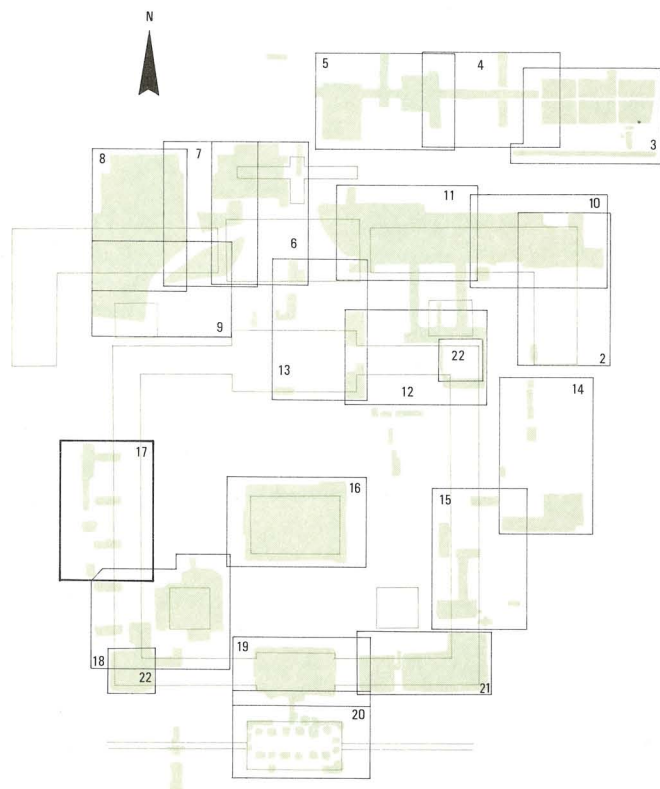

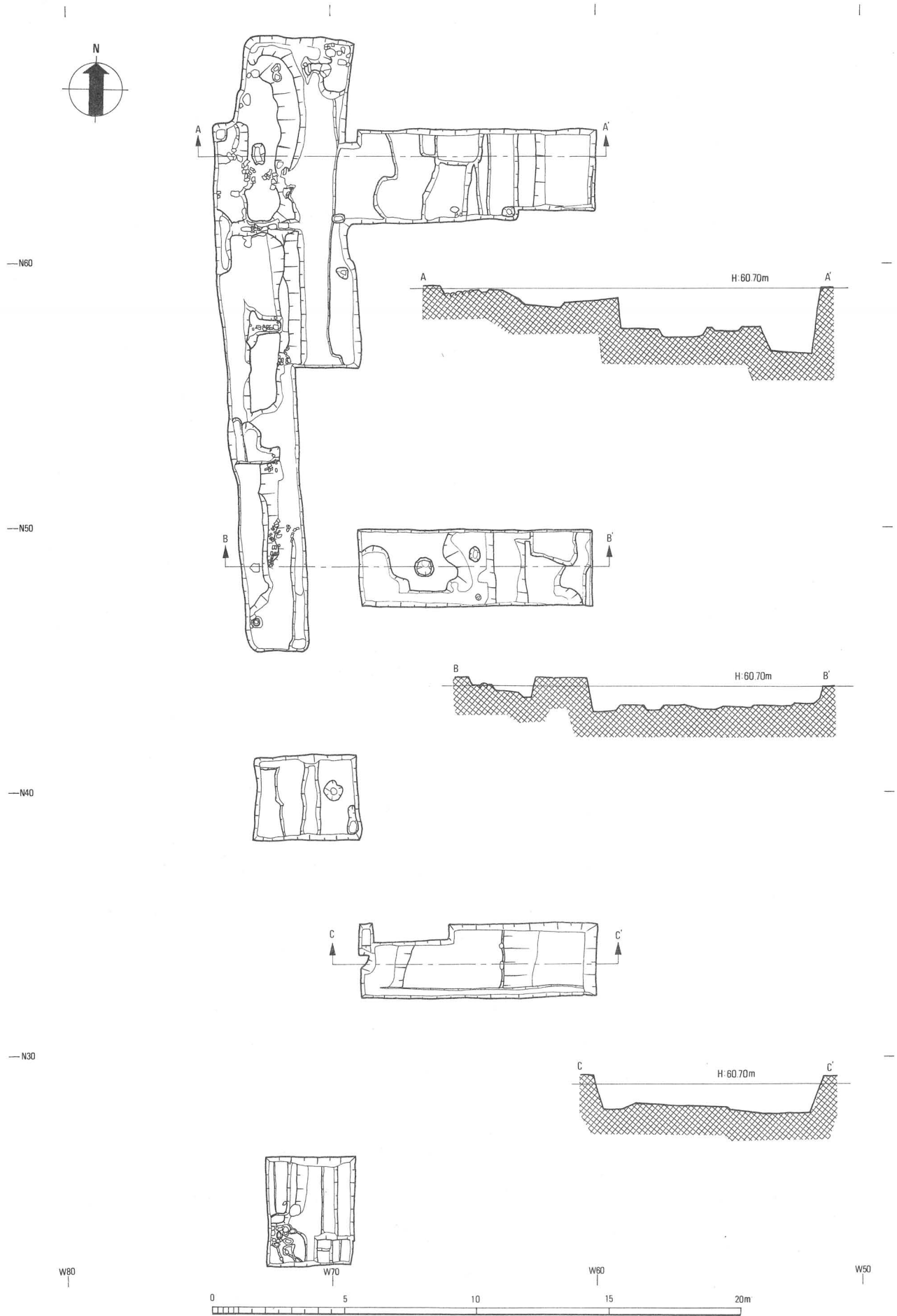

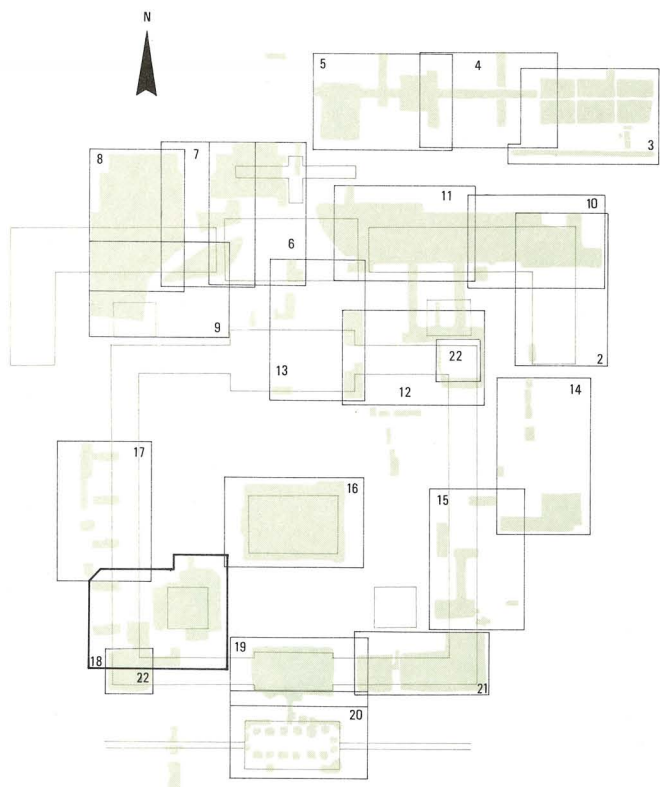

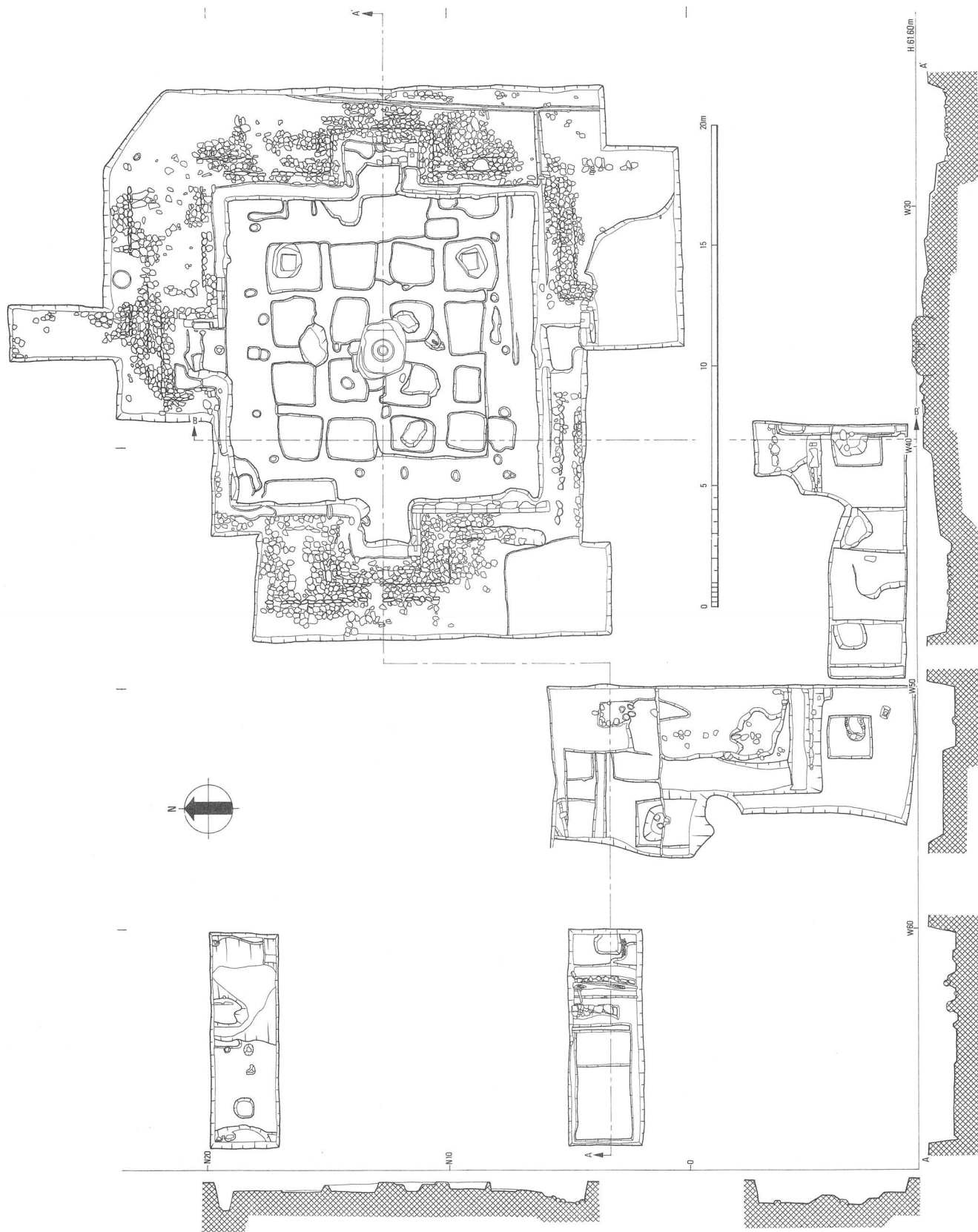

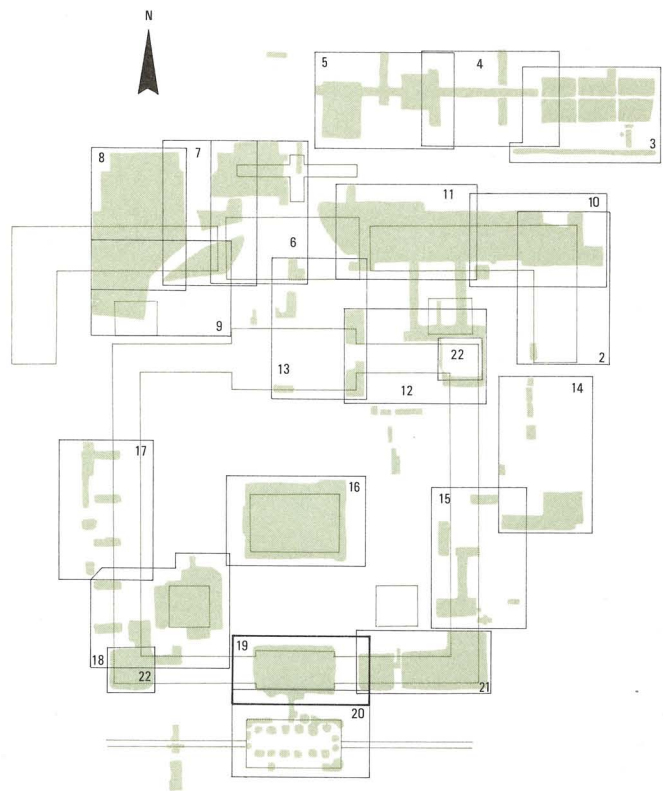



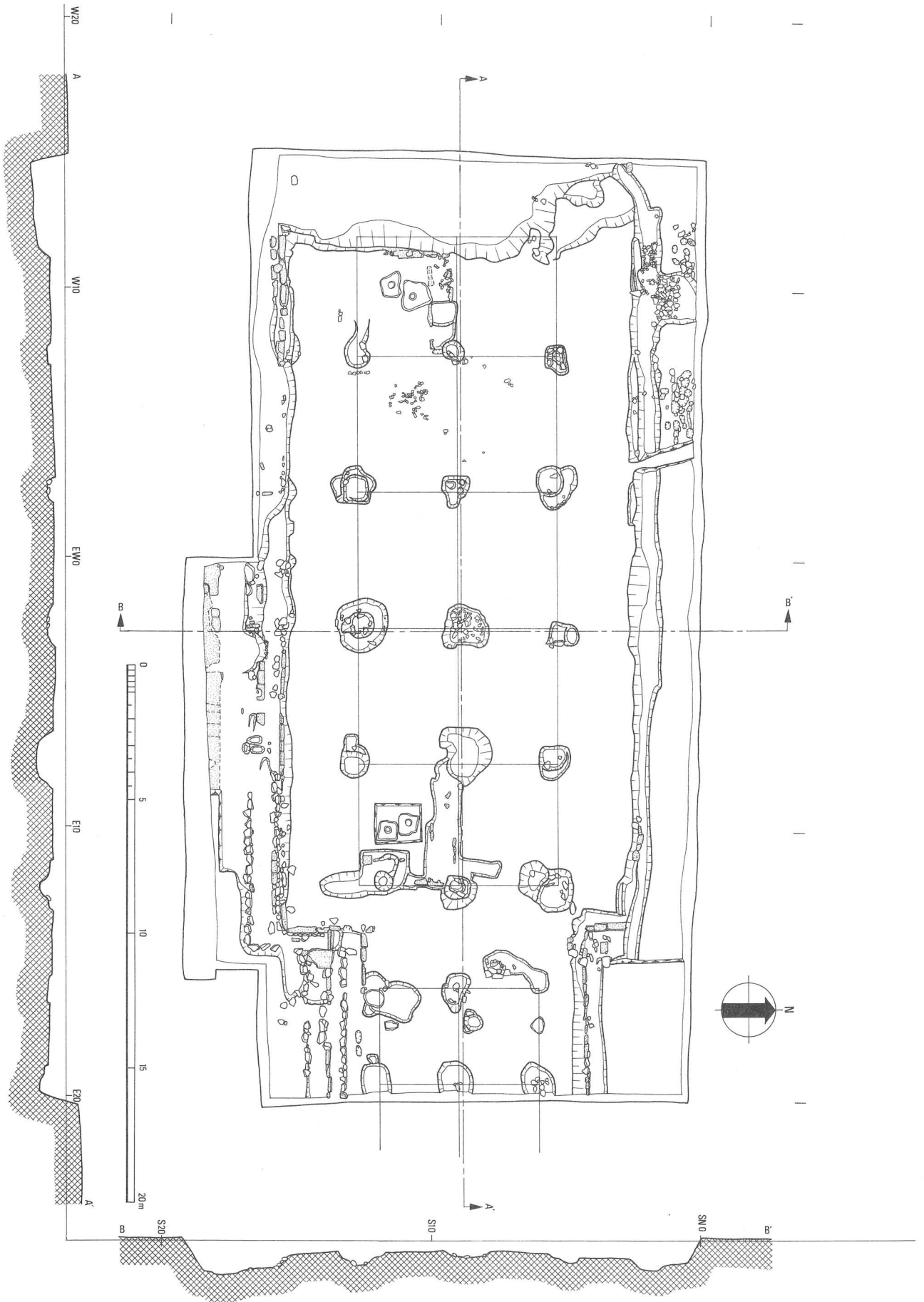

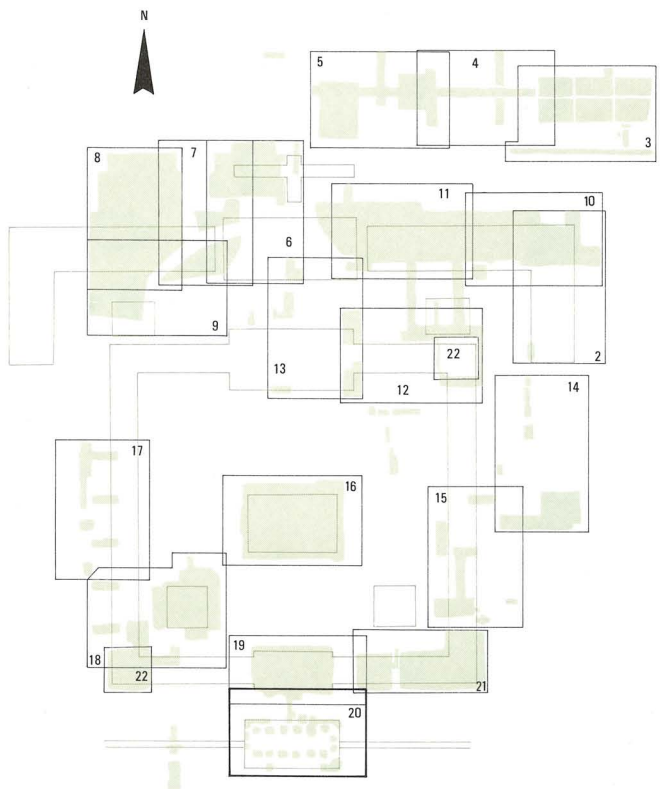

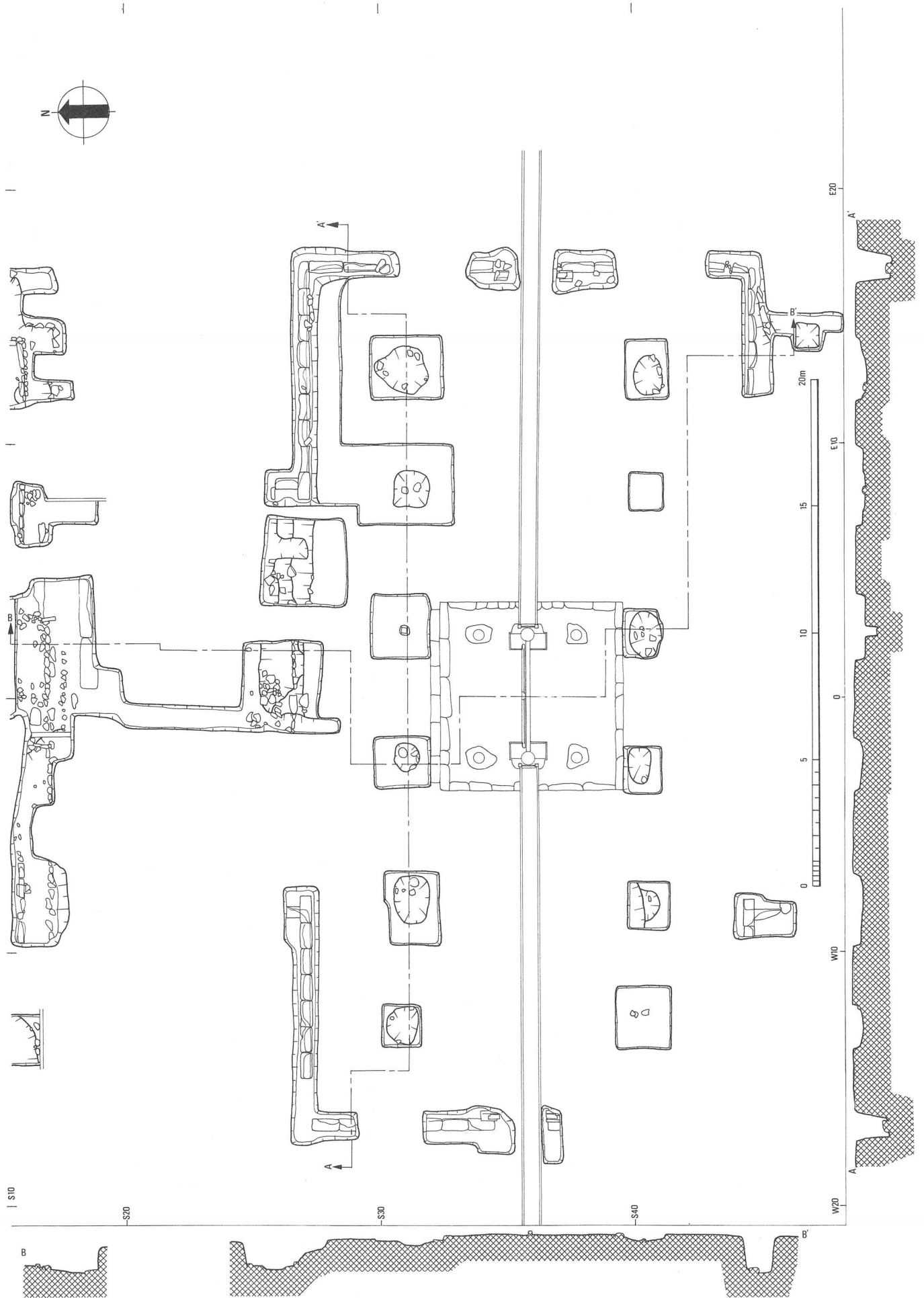



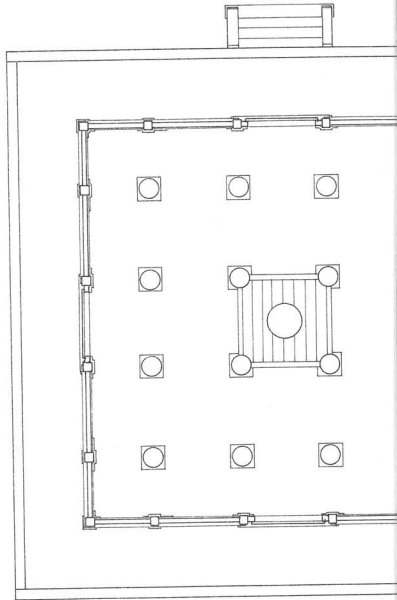
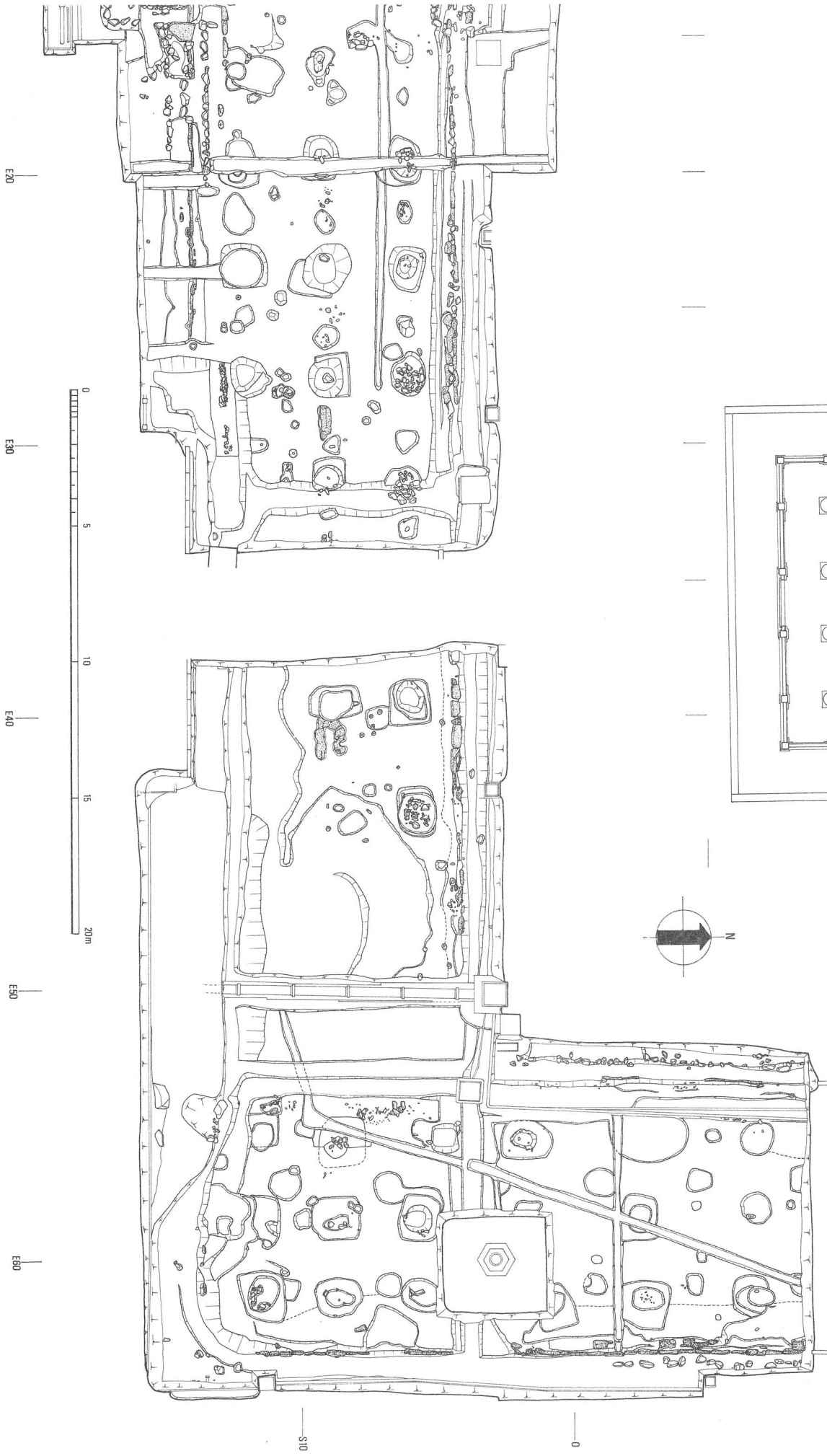

(回廊発掘区の土層はPL. 48参照)

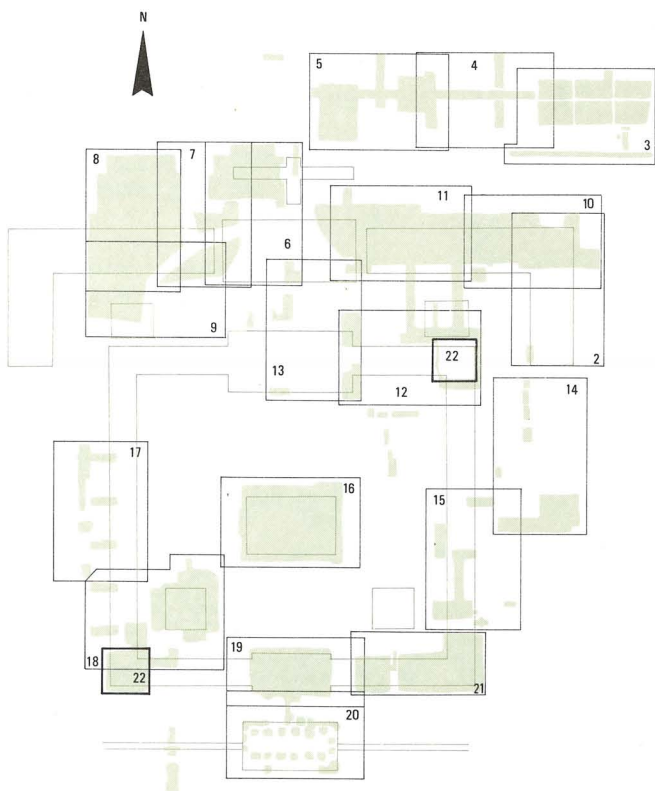



回廊東北隅

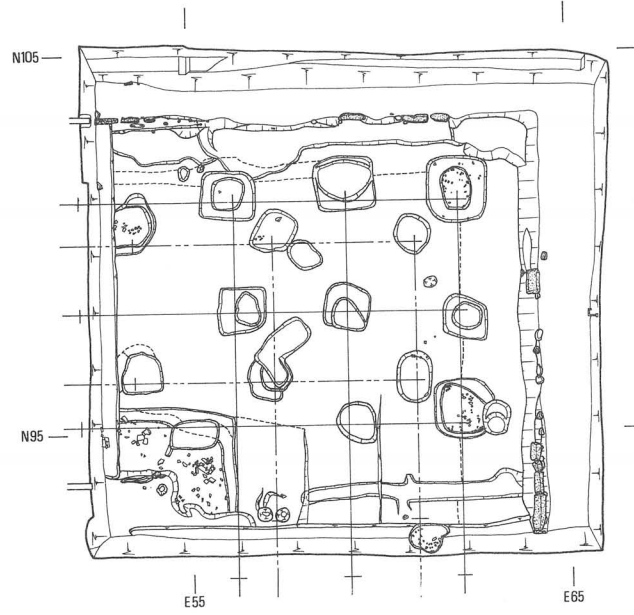

回廊西南隅

